



Coast Freshe[®] COMMERCIAL

CONTRAST THERAPY PLUNGE

By **Coast Spas[®]**



2026 Owner's Manual

CONTRAST THERAPY COMMERCIAL

Coast Spas Manufacturing
6315 202 Street Langley, BC Canada V2Y 1N1
info@coastspas.com
www.coastspas.com



CONTRAST THERAPY COMMERCIAL

At Coast Spas, we're dedicated to enhancing your health and wellness through our Hot Tubs, Swim Spas, and Contrast Therapy Commercial. Built with advanced technology and trusted quality, our products are designed to help you relax, recover, and feel your best every day.

We're proud to be known for crafting the World's Best Built Spas®, and our Contrast Therapy Commercial is a standout choice for boosting recovery and improving circulation. Whether for personal relaxation, therapy, or shared moments with loved ones, our units are made to enrich your life year-round.

We hope you enjoy the comfort, performance, and well-being our products bring for many years to come. Thank you for choosing Coast Spas.

CONGRATULATIONS!



YOU'RE ALMOST READY TO ENJOY YOUR NEW CONTRAST THERAPY COMMERCIAL!



CONGRATULATIONS!

YOU'RE ALMOST READY TO ENJOY YOUR NEW UNIT!

Before you begin to enjoy your Contrast Therapy Commercial, please take a moment to submit your warranty. For registering your unit, you will need the serial number. Picture below will help you locate the serial number on your Contrast Therapy Commercial.



You can register your unit by using this link. <https://coastspas.microsoftcrmportals.com/>

FOR YOUR REFERENCE

Owner's name: _____

Address: _____

Contact: _____

Email: _____

Serial number: _____

Purchase Date: _____

Delivery Date: _____

Dealer Name: _____

Contact your selling dealer if you have any queries related to your Contrast Therapy Commercial. Coast Spas authorized dealers are trained professionals who can assist you with parts, set up, operations, maintenance, and technical support.

DISCLAIMER: At the time of print, this manual is accurate in its information. Coast Spas reserves the rights to change or modify any unit designs and/or features without notification. To check on updates or for other information, please visit www.coastspas.com

UNLOADING AND UNBOXING INSTRUCTIONS

SAFETY FIRST

Your Contrast Therapy Commercial is large and heavy, improper handling may lead to injury or product damage. Please review the following safety guidelines before unloading.

General Safety

- Team Lift Only. It requires two or more people to lift or move. Never attempt to lift alone.
- Wear Safety Gloves & Footwear. Protect hands from sharp edges and feet from impact injuries.
- Do Not Drop or Tip Over. May cause damage to the structure or internal components.
- Keep Children & Pets Clear. Keep the area clear during unboxing and set up.
- Use Proper Lifting Techniques. Bend at the knees, not the waist. Keep your back straight.
- Lift from Designated Points. Only lift from stable, reinforced areas indicated on the box.

Handling Tip

- Use Built-In Plastic Handles. Your cold plunge is packaged with two plastic handles, one at the front and one at the back of the box. These handles are designed to assist with lifting and maneuvering the unit safely.
- Do not lift from the sides of the box or attempt to drag the unit.

Equipment Safety

- Use tools like pallet jack, dolly, or forklift if available.
- Do not use straps around the unit body for lifting. They may compress or deform the shell.

UNLOADING INSTRUCTIONS

Prepare the Area: Clear a space wide enough to maneuver the unit. Confirm the drop-off location is level and safe for unloading.

Inspect Upon Delivery: Before signing the delivery receipt, inspect the box and pallet for damage. Take photos of any damage and note it on the delivery form.

Unloading Options:

- With Equipment: Use a forklift or pallet jack to move the product safely.

- Without Equipment: Have 2–4 people lift using the plastic handles at the front and back.
- Avoid dragging or rolling unless specified as safe by the manufacturer.

UNBOXING INSTRUCTIONS

Remove Outer Packaging: Use a box cutter or scissors with caution, do not cut too deep. Remove shrink wrap, straps, and foam padding.

Check Package Content: Make sure the Contrast Therapy Commercial is the correct color and came with the ordered accessories.

Inspect the Product: Look for dents, cracks, or missing components. Contact your dealer within 48 hours if anything is missing or damaged.

Dispose of Packaging Safely: Do not leave plastic wrap or foam where it could be a tripping hazard. Recycle where possible.

QUICK TIPS:

- If the unit is not installed immediately, store upright on a flat surface.
- Do not expose the unboxed unit to direct sunlight or rain until it's installed.
- Keep the serial number (usually located on the inside lip) for your warranty records.

COVER INSTALLATION INSTRUCTIONS

1. Position the Cover
 - Place the cover evenly over the Contrast Therapy Commercial, ensuring the hinge aligns with the center for proper folding.
2. Attach Locking Clips Using Adhesive
 - Use high-strength double-sided adhesive tape (such as 3M VHB) to secure the locking clips to the acrylic cabinet.
 - Clean the surface thoroughly with isopropyl alcohol before applying tape for maximum adhesion.
 - Press clips firmly and allow adhesive to cure for at least 24 hours before applying tension.
3. Install Locking Straps
 - Attach straps to the clips and adjust for a snug fit.
 - Test the lock mechanism to ensure proper engagement.

Safety Note: Always lock the cover when not in use to prevent unauthorized access and reduce heat transfer.

SAFETY COVER CLIP INSTALLATION

This unit uses adhesive cover clips instead of screws. Do not drill into the unit acrylic, because this can crack or damage the surface.

Installation steps

1. Place the cover on the unit first and make sure it seals the unit perfectly.
2. Pull each strap down to find the exact clip location.
3. Ensure unit acrylic surface is clean and dry.
4. Remove the white paper from the adhesive backing on the cover lip.
5. Position the clip on the unit acrylic.
6. Press the clip firmly with your palm so the adhesive bonds to the acrylic.
7. Hold the clip under pressure for a few minutes before attaching the cover strap.

WARNING: Do not use screws or drill into the unit acrylic. This may cause permanent damage to the unit surface.



SHIPPING INSTRUCTIONS

⚠ IMPORTANT NOTICE

Contrast Therapy Commercial contain sand filters and an integrated chiller system. These components are highly sensitive to movement and orientation. Failure to follow these instructions may result in damage to internal systems and void the warranty.

REQUIRED SHIPPING ORIENTATION

- **Ship Flat Only.** The spa must be shipped horizontally on a reinforced pallet. Do not ship upright or on its side.

PACKAGING & SECURING

1. Strapping

- Use heavy-duty nylon straps.
- Add corner protectors under straps to prevent shell damage.

2. Component Stabilization

- Brace sand filters and chiller with foam blocks or rigid supports.
- Wrap delicate components with bubble wrap or foam sheets.

3. Shrink Wrapping

- Wrap spa and pallet with industrial grade shrink wrap.

HANDLING INSTRUCTIONS

1. Use forklift or pallet jack only under the pallet.
2. Do not tilt or rotate the spa during loading/unloading.
3. Avoid stacking other freight on top of the spa.

DELIVERY CHECKLIST

1. Confirm spa arrived flat and secured.
2. Inspect for any signs of tipping or impact damage before signing delivery receipt.



TABLE OF CONTENTS

Cover Page	Page	1
Thank You Letter from Coast Spas	Page	2
Registering your Contrast Therapy Commercial	Page	3
Unloading and Unboxing Instructions	Page	4
Cover and Safety Cover Clip Installation Instructions	Page	5
Shipping Instructions	Page	6
Table of Contents	Page	7-8
Basic Information	Page	9
Important Safety Instructions	Page	10-12
Chiller Basic Information and Control Panel Instructions	Page	13-15
Chiller Quick Reference Guide	Page	16
Contrast Therapy Commercial Smart Control App Set up	Page	17-24
Chiller Troubleshooting Guide	Page	25-27
Glossary of Terms	Page	28
Contrast Therapy Commercial General Layout	Page	29
Contrast Therapy Commercial Specification	Page	30
Contrast Therapy Commercial Care Guide	Page	31-33
Coast Spas Chemicals	Page	34-35
Contrast Therapy Commercial Chemical Safety Guidelines	Page	36
Contrast Therapy Commercial Set Up Guide	Page	37-38

Contrast Therapy Commercial Water Care Guide	<i>Page</i>	39-42
Water Clarity Troubleshooting	<i>Page</i>	43
Draining & Winterizing	<i>Page</i>	44-45
Auto Dosing System	<i>Page</i>	46
Sand Filter Installation Instructions	<i>Page</i>	47
Contrast Therapy Commercial How-To Videos	<i>Page</i>	48
Contrast Therapy Commercial Service Log	<i>Page</i>	49-51



PLEASE READ YOUR ENTIRE OWNER'S MANUAL BEFORE UNIT OPERATION



Basic Information

Water Care

IMPORTANT: Caring for your water by ensuring proper chemical usage is the single most important thing you can do to keep your Contrast Therapy Commercial in good condition.

WARNING: Improper chemical usage and maintenance will quickly lead to severe issues with your unit and can affect the unit equipment, jets, pumps, and all other components in contact with the spa water.

All units are susceptible to damage from unbalanced spa water.

Always maintain your water chemistry within the following parameters.

pH	7.2 - 7.8
Chlorine	1.0 - 3.0 ppm
Bromine	2.0 - 5.0 ppm
Total Alkalinity	100 - 120 ppm
Calcium Hardness	150 - 250 ppm

Electrical

All self-contained units use 110VAC electrical spa packs.

110VAC: requires an isolated 15 Amp circuit breaker, an isolated circuit with no other appliances or lights on the circuit at any time. Extension cords are not to be used in conjunction with the operations of the unit. Low voltage damage could result, and this is not covered under warranty.

IMPORTANT: Units with 110V means that the jets and heater will not work at the same time.

NOTE: All components must be 110V-120V. No 240V components allowable.

The electrical circuit must be installed by a certified electrician and approved by a local building or electrical inspector.

Surface

Your new portable Contrast Therapy Commercial must be placed on a firm, flat, and level surface, so that the weight is supported uniformly. We recommend no less than a 3" (93 mm) thick concrete slab. Wood decking or balconies must be constructed to support 150 pounds per square foot (730 kg/m²). Refer to the local and current building codes in your area. Should your new unit need to go through the gate or space – restricted area, ensure you've communicated those limitations with your dealer to avoid delivery complications.

NOTE: Damage caused by alternate decking methods may void the unit warranty. Contact your dealer if you have any questions regarding unit location and placement.

Transport

Your new Contrast Therapy Commercial has left the factory cleaned and polished and ready to begin operation after passing our many quality and operational tests. However, depending on your location in the world, your unit may have spent days or even weeks in transit before arriving at your location. Please ensure that before filling or operating your unit that you check all electrical and plumbing connections are securely connected in the equipment area as they might have loosened during shipping. If any dirt has accumulated, you will want to remove with a clean cloth or sponge using warm water.

IMPORTANT SAFETY INSTRUCTIONS

READ AND FOLLOW ALL INSTRUCTIONS CAREFULLY

⚠️ IMPORTANT: Your physiological response to hot water is subjective and depends on your age, health, and medical history. If you don't know your tolerance to hot water, or if you get a headache, or become dizzy or nauseous when using your hot tub, get out and cool off immediately.

⚠️ DANGER: Risk of Injury. The suction fittings in the Contrast Therapy Commercial are sized to match the specific water flow created by the pump. Should the need arise to replace the suction fittings or the pump, be sure that the flow rates are compatible. Never operate the unit if the suction fittings are broken or missing. Never replace a suction fitting with one rated less than the flow rate marked on the original suction fitting.

⚠️ DANGER: Risk of Accidental Drowning. Do not allow children to be in or around the unit without adult supervision. Keep the Contrast Therapy Commercial cover on and locked when not in use. See enclosed instructions with the cover for locking procedures.

⚠️ DANGER: Risk of Electrical Shock. The electrical supply for this product must include a suitably rated switch or circuit breaker to open all ungrounded supply conductors to comply with section 422-20 of the National Electrical Code, ANSI/NFPA 70. The disconnect must be readily accessible and visible to the unit occupant but installed at least 5 feet (1.5 m) from the Contrast Therapy Commercial water.

READ, FOLLOW AND SAVE THESE INSTRUCTIONS

- a) A green colored terminal or a terminal marked G, Gr, Ground, Grounding or the symbol * is located inside the supply terminal box or compartment. To reduce the risk of electric shock, this terminal must be connected to the grounding means provided in the electric supply service panel with a continuous copper wire equivalent in size to the circuit conductors that supply this equipment.
- b) At least two lugs marked "Bonding Lugs" are provided on the external surface or on the inside of the supply terminal box compartment. To reduce the risk of electric shock, connect the local common bonding grid in the area of the unit to these terminals with an insulated or bare copper conductor not smaller than No. 6 AWG.
- c) All field-installed metal components such as rails, ladders, drains or other similar hardware within 5 feet (1.5 m) of the unit shall be

bonded to the equipment grounding buss with copper conductors not smaller than No. 6 AWG.

⚠️ WARNING: To Reduce the Risk of Injury. The water in a Contrast Therapy Commercial should never exceed 104 °F (40 °C). Water temperatures between 100 °F (38 °C) and 104 °F (40 °C) are considered safe for a healthy adult. Lower water temperatures are recommended for young children and when unit use exceeds 10 minutes. Since excessive water temperatures have a high potential for causing fetal damage during the early months of pregnancy, pregnant or possibly pregnant women should limit Contrast Therapy Commercial water temperatures to 100 °F (38 °C). If pregnant, please consult your physician before using a Contrast Therapy Commercial. Before entering the unit, the user should measure the water temperature with an accurate thermometer since the tolerance of water temperature regulating devices may vary as much as +/- 5 °F (2 °C). People suffering from obesity or a medical history of heart disease, low or high blood pressure, circulatory system problems or diabetes should consult a physician before using a Contrast Therapy Commercial.

⚠️ CAUTION: Risk of Hyperthermia: Hyperthermia occurs when the internal temperature of the body reaches a level several degrees above the normal body temperature of 98.6 °F (37°C). The symptoms of hyperthermia include drowsiness, lethargy, and an increase in the internal temperature of the body. Prolonged immersion in hot water may induce hyperthermia. A description of the causes, symptoms, and effects of hyperthermia are as follows:

- Unawareness of impending hazard.
- Failure to perceive heat.
- Failure to recognize the need to exit unit.
- Physical inability to exit unit.
- Fetal damage in pregnant women; and
- Unconsciousness and danger of drowning.

⚠️ WARNING: Children should not use the Contrast Therapy Commercial without adult supervision.

⚠️ WARNING: Do not use the Contrast Therapy Commercial unless all suction guards are installed to prevent body and hair entrapment.

⚠️ WARNING: People with infectious diseases should not use a Contrast Therapy Commercial.

⚠ WARNING: To avoid injury, exercise care when entering or exiting the Contrast Therapy Commercial.

⚠ WARNING: Pregnant or possibly pregnant women should consult a physician before using a Contrast Therapy Commercial.

⚠ WARNING: Water temperatures more than 38 °C (100 °F) may be injurious to your health. Before entering the Contrast Therapy Commercial, measure the water temperature with an accurate thermometer.

⚠ WARNING: Prolonged immersion in a Contrast Therapy Commercial may be injurious to your health.

⚠ WARNING: Do not permit electric appliances (such as lights, telephone, radio, television, etc.) to be within 5 feet (1.5m) of Contrast Therapy Commercial unless such appliances are built-in by the manufacturer.

⚠ WARNING: People using medication and/or having an adverse medical history should consult a physician before using a Contrast Therapy Commercial.

⚠ WARNING: Maintain water chemistry in accordance with the manufacturer's instructions.

⚠ WARNING: The equipment and controls shall be located no less than 1.5 meters horizontally from the Contrast Therapy Commercial.

⚠ WARNING: Do not use drugs or alcohol before or during the use of Contrast Therapy Commercial to avoid unconsciousness and possible drowning. The use of alcohol or drugs can greatly increase the risk of fatal hyperthermia in units.

⚠ WARNING: Avoid swallowing water to prevent gastrointestinal illnesses or Legionnaires' disease from microbes like Cryptosporidium and Legionella.

⚠ CAUTION: Observe a reasonable time limit when using the Contrast Therapy Commercial. Long exposures at higher temperatures can cause high body temperature. Symptoms may include dizziness, nausea, fainting, drowsiness, and reduced awareness. These effects could possibly result in drowning.

⚠ CAUTION: Enter and exit the unit slowly. Wet surfaces can be very slippery.

⚠ CAUTION: For exercise, the water should not exceed 90 °F (32° C).

⚠ CAUTION: Use the straps and clip tie downs to secure the cover when not in use. This will help to discourage unsupervised children from entering the Contrast Therapy Commercial and keep the unit cover secure in high-wind conditions. There is no representation that the cover, clip tie-downs, or actual locks will prevent access to the unit.

⚠ CAUTION: Proper chemical maintenance of Contrast Therapy Commercial water is necessary to maintain safe water and prevent possible damage to unit components. Maintain water chemistry in accordance with manufacturer's instructions.

⚠ WARNING: Cold and Hypothermia Risk: Do not operate below 50°F (10°C) without a winterization plan. Extended exposure to cold water can cause hypothermia and cardiac distress.

Hypothermia Safety

Cold-water immersion can be beneficial, but extended exposure may lower body temperature and cause hypothermia.

How the Body Loses Heat

The body loses heat through:

- **Conduction** – direct contact with cold surfaces or water.
- **Convection** – moving water or air around the body.
- **Radiation** – heat escaping from the skin.
- **Evaporation** – moisture on the skin cooling the body.

If the body's natural warming mechanisms, like shivering, are no longer effective, hypothermia can occur.

WARNING

Mild Hypothermia: Shivering, goosebumps, slight loss of coordination.

- **Moderate Hypothermia:** Intense shivering, slurred speech, sluggish movements, impaired motor skills.
- **Severe Hypothermia:** Rigid muscles, confusion, loss of shivering, blue or pale skin, irregular heartbeat, or loss of consciousness.

What to Do:

- Exit the cold water immediately.
- Warm the body gradually using blankets or warm clothing.
- Seek medical attention if symptoms are severe.

⚠ **Important:** Always monitor your exposure time in cold water and never exceed safe limits.

⚠ **CAUTION: Hypothermia Symptoms:** Extended use increases the risk of hypothermia. Symptoms such as severe shivering, confusion, speech difficulties, loss of motor control, muscle rigidity, blue skin, or an irregular heartbeat.

⚠ **CAUTION: Chiller Freezing Risk:** Turn off the chiller immediately if the water is not flowing as it can cause ice to build up and damage the chiller unit.

⚠ **CAUTION: Winterization Requirement:** To prevent damage to the chiller unit and plumbing system, drain and winterize the Contrast Therapy Commercial if the ambient temperature drops to 36°F (2°C) or below, especially during winter.

⚠ **CAUTION: Chiller Transport and Handling:** Do not turn the chiller upside down. Failure to follow this guideline may cause damage to the Contrast Therapy Commercial.

WARNING

⚠ **NO DIVING OR JUMPING:** To prevent injury, never dive or jump into the Contrast Therapy Commercial unit.

⚠ **FOR TRAINED PERSONNEL ONLY:** Commercial use requires trained staff. Maintain water-testing logs for compliance and safety.

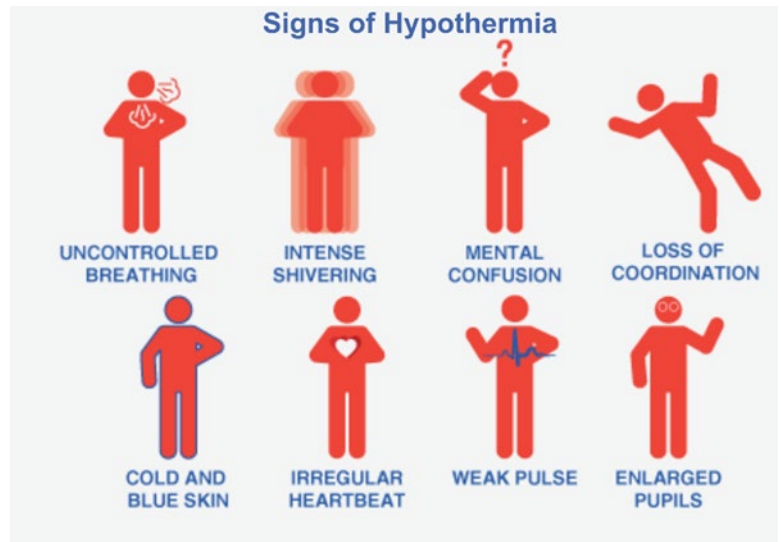

CONTRAST THERAPY COMMERCIAL CHILLER BASIC OPERATION

CHILLER CONTROL PANEL INTERFACE

HOME SCREEN DISPLAY

Current Measured Temperature

Up Button.
Press to increase the values.

Down Button.
Press to decrease the values.
- Short Press to turn screen backlight ON/OFF.

Setting Button.
- Short press to enter temperature setting.
- Long press to enter the internal parameter settings.

Emergency stop button.
- Short press to stop the compressor.
- Long press to use locking function.

**Note: After enter setting, it will automatically exit after a few seconds if no further action is taken.*

WIFI Indicator

Cooling Mode Indicator

Start Temperature

High Temp Alarm

Low Temp Alarm

Lock

Stop Temperature











Buzzer Indicator

Temperature Unit

Compressor Indicator
- Solid Lit: Compressor Is Working
- Flashing: Compressor Emergency Stop
- Not Lit: Compressor Stop Working

CHILLER CONTROL PANEL INSTRUCTIONS

1. Wipe the surface of the Contrast Therapy Commercial before first use to remove dust and residue.
2. Insert the fill hose into the Contrast Therapy Commercial and add water until it reaches the appropriate level. Fill with distilled or tap water, leaving 4-4.5 inches/11.00 centimeters from the top. If the water contains high mineral levels it is recommended to use a prefilter.





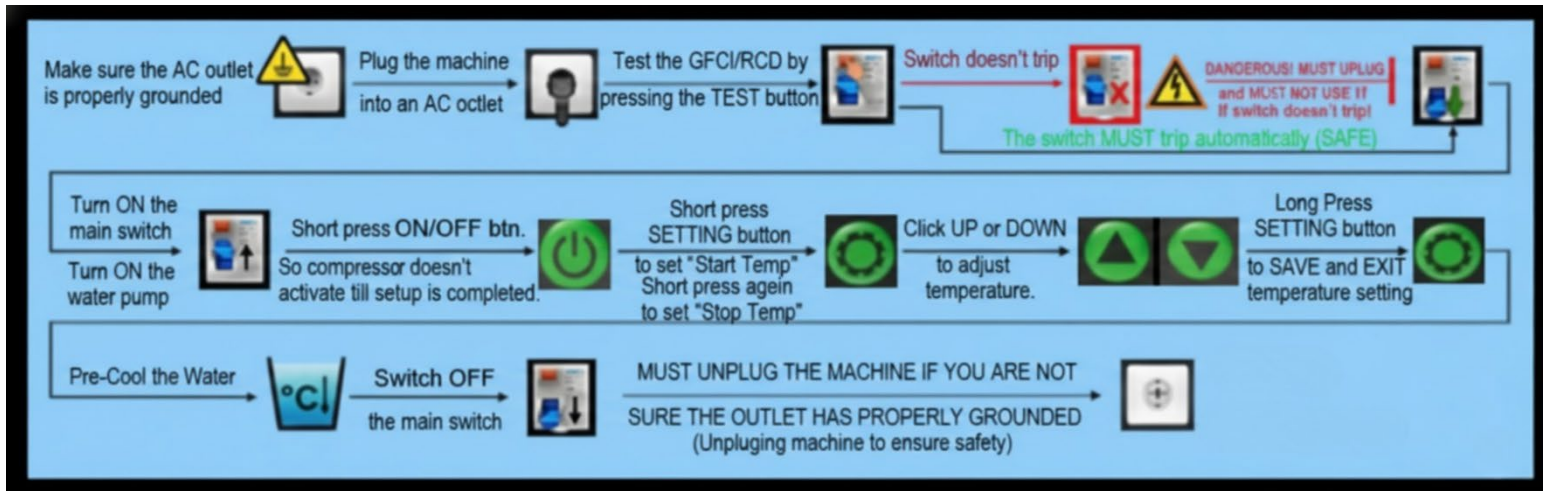

Note: Avoid over filling the Contrast Therapy Commercial
3. Plug the power cord into an outlet to power up the Contrast Therapy Commercial GFCI Box activate the water pump, allowing water to flow and circulate through the chiller system. If the pump makes a humming noise but no water movement, check the filter housing and strainer housing for airlock and follow the next step if needed.
4. Loosen the main filter housing and strainer housing to release any air lock, allowing water to fill the canister. Once the water reaches the top, tighten the housing back. If the canister is already filled with water, you can skip this step.
5. Remove the cap of the drain valve then open the drain valve to release any trapped air. Once the air is purged and the line is filled with water, close the valve and replace the cap.
6. Power on the chiller using the power switch. **Press**  as soon as the screen lights up to "Hold" the chiller compressor from starting before the settings are completed.
7. Short press  once, to enter the temperature setting. Once the "Start Temp" message begins to flash. Use  and  to adjust the temperature values.
8. Short press  once again, the "Stop temp" message will be flashing. Use  and  to adjust the temperature values.
9. Long press  to save and exit the temperature setting. Note: The chiller will not operate if the set temperature is higher than the current water temperature.
10. After 3 minutes, check the compressor indicator with the  symbol to confirm if it is solid or flashing. If it is flashing, short press the button  once to turn it on.
11. The compressor will activate, and the fan will start running. The chiller will gradually lower the water temperature to the set level.

Note: The compressor has a 3-minute delay after each start /reset cycle.

DISCLAIMER: The real water temperature in the tub would be +1.5/-1 degrees Celsius different from the temperature shown on the screen because the water temperature sensor is not in the tub.



BUTTON OPERATION

Button Operation Instructions			
Interface	Main Screen Display	Set Start/Stop Temperature	Set System Parameters
Button			
	Quickly press to enter the Start/Stop Temperature settings interface. Press and hold to enter the system parameter settings interface.	Quickly press to switch between the modified start and stop temperature values. Press and hold to save the value and exit.	Quickly press to toggle modified system parameters. Press and hold to save the value and exit.
	Short press: Not applicable. Long press: Not applicable.	Quickly press to increase the parameter value. Press and hold to quickly increase the parameter value.	Quickly press to increase the parameter value. Press and hold to quickly increase the parameter value.
	Quickly press to turn the screen backlight ON or OFF. Long press: Not applicable.	Quickly press to decrease the parameter value. Press and hold to quickly decrease the parameter value.	Quickly press to decrease the parameter value. Press and hold to quickly decrease the parameter value.
	Quickly press to toggle the emergency stop ON or OFF. Press and hold to enable or disable the button lock.	Short press: Not applicable. Long press: Not applicable.	Press quickly to toggle ON/OFF functions: OTP, LTP, dLy. Note: "--" indicates the function is turned OFF. Long press: Not applicable.

NOTE: Please refrain from modifying any parameters other than the **start temp, stop temp, compressor emergency ON/OFF**. Improper adjustments may cause the chiller to malfunction.

CONTRAST THERAPY COMMERCIAL
CHILLER QUICK REFERENCE GUIDE

1. Carry handles: The Contrast Therapy Commercial Chiller Carry Handle offers a sturdy, comfortable grip for effortless transport.
2. Control Panel: Displays information and enables easy operation of the Contrast Therapy Commercial chiller.
3. Vents: Ensure proper airflow to maintain optimal operating temperatures for Contrast Therapy Commercial equipment.
4. Rubber Stander: Stabilizes the Contrast Therapy Commercial chiller and absorbs operational vibrations.
5. Cooling Fan: Ensures effective heat dissipation for optimal performance and longevity of the Contrast Therapy Commercial chiller.
6. Power Cord: Connects the Contrast Therapy Commercial chiller to an AC power outlet via the Contrast Therapy Commercial GFCI box.
7. Water Outlet: Connects the water hose to the inlet of the Contrast Therapy Commercial to return cooled water.
8. Water Inlet: Connects the water hose from the outlet of the Contrast Therapy Commercial for cooling with the chiller.
9. Power Switch: Turns the Contrast Therapy Commercial on and off.

CONTRAST THERAPY COMMERCIAL SMART CONTROL APP SET UP

Your Contrast Therapy Commercial includes built-in Wi-Fi capability for remote monitoring and temperature control using the Sinilink mobile app. Follow the steps below to connect your chiller to your smartphone.

1. Download the App

- You can download the Sinilink app for free:
- For iPhone (iOS): Visit the App Store and search "Sinilink"
- For Android: Visit the Google Play Store and search "Sinilink"
- Or scan the QR Code below:



Once downloaded, install the app on your smartphone and register an account to proceed.



IMPORTANT: Ensure that your smart device is connected to Wi-Fi 2.4G only and that Bluetooth is enabled. Also, confirm that both your smart device and the Contrast Therapy Commercial Chiller are within the same Wi-Fi 2.4G coverage area before proceeding with the app set up.

NOTE: Contrast Therapy Commercial is not compatible with Wi-Fi 5G.



NOTE: When your smart device detects "Sinilink App" in Bluetooth search, **do not connect** to it directly. This Bluetooth connection must be made **within the app**.

If you have already paired it through your device's Bluetooth settings, please **cancel the pairing** and search again. Connecting outside the app may prevent successful pairing within the app.

2. Create or Log into Your Account

1. Open the Sinilink App and create an account.
2. Click "**Register**" under the **Login** tab.
3. Follow the on-screen instructions to complete the registration process.

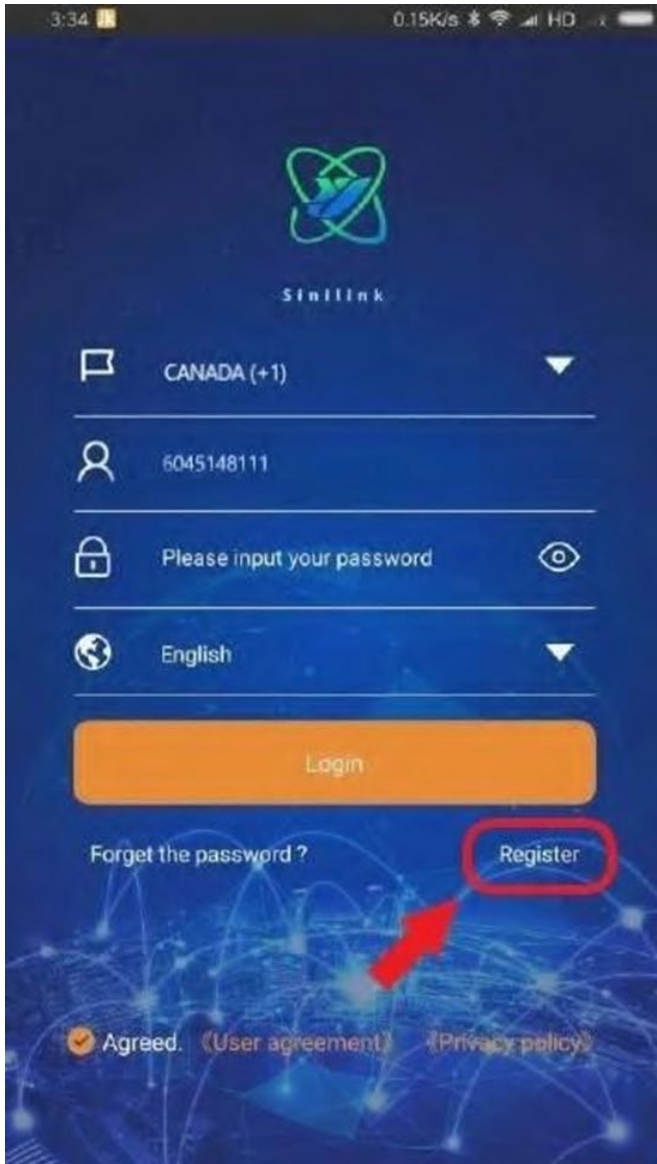

3. Pairing Your Chiller

Click on "**Add a Device**" or tap the "+" symbol in the lower right corner.

NOTE: Ensure that your device is connected to your home Wi-Fi (2.4G only) before proceeding.

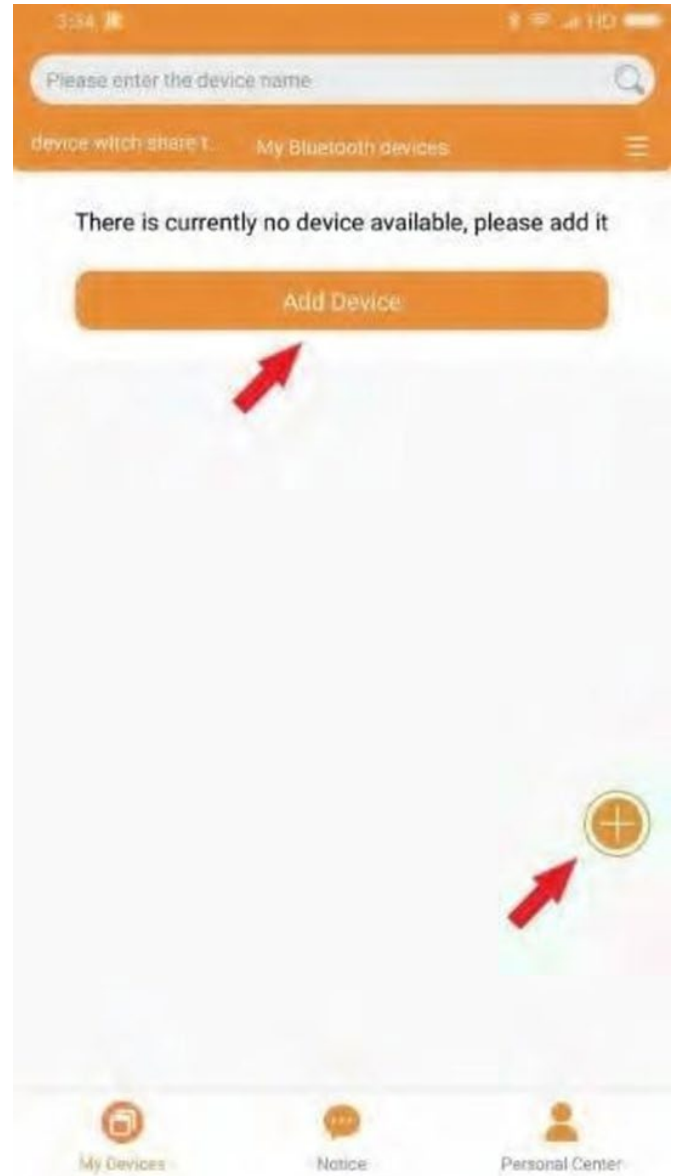

4. Select **Compatibility Mode**.

Do not select **Touch Mode** or **Bluetooth Devices** during this step.



5. On this screen, **do not select anything**. Simply click **"Next"** at the bottom without making any changes.

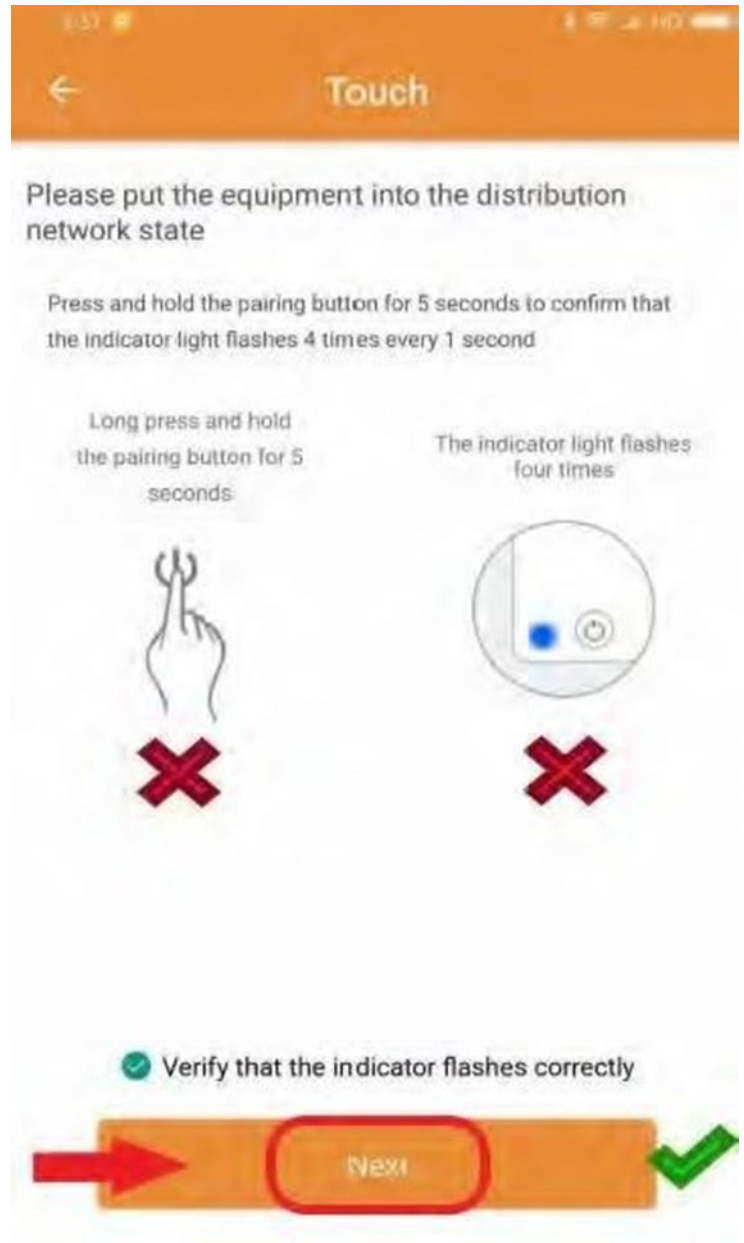

- 6. Tap to select the **checkmark**, which will highlight it. This action will change the "Next" button from **grey to orange**. Then, tap "Next" to proceed.

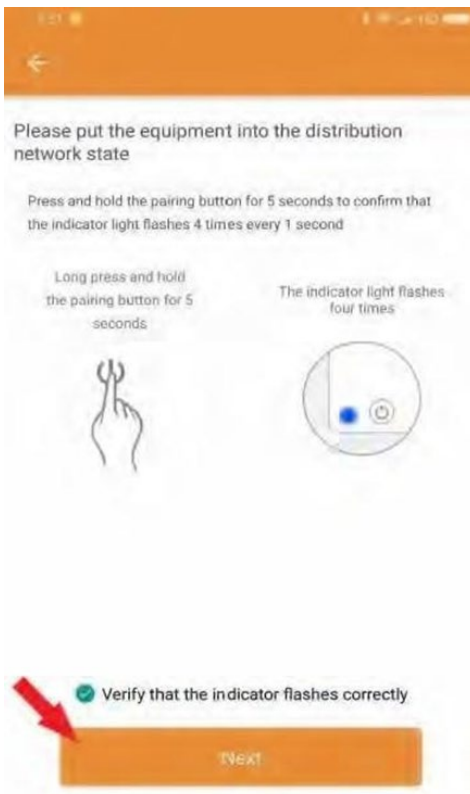

- 7. Select your **home Wi-Fi (2.4G only)** and enter your **Wi-Fi password**, then click "Next Step" to continue.

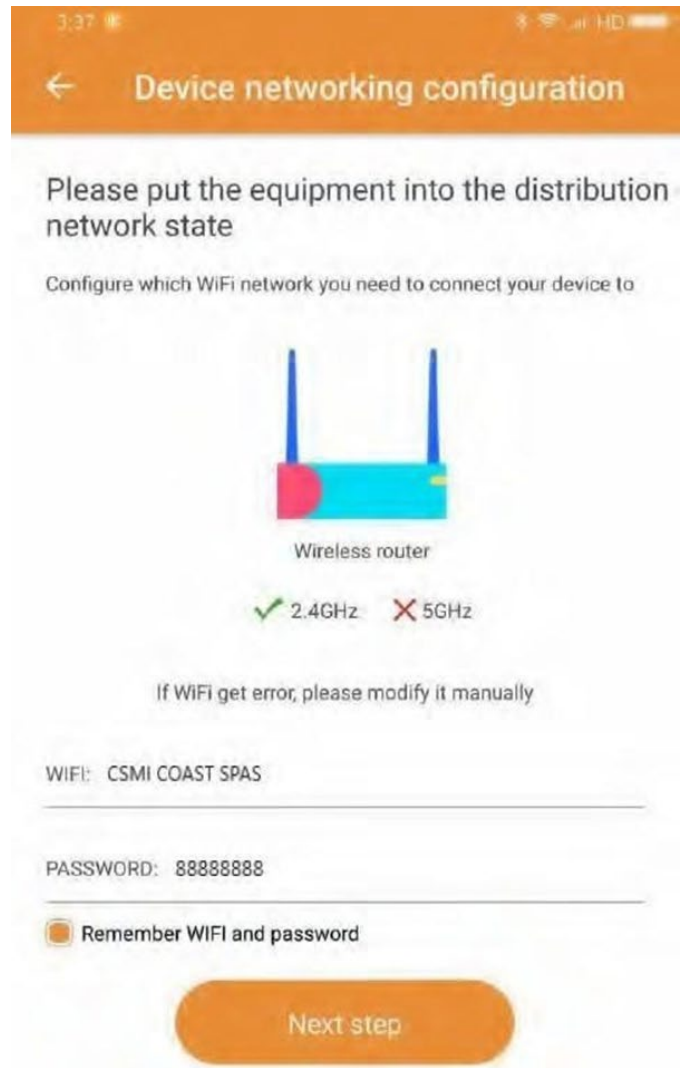

- Enter a custom name for your Contrast Therapy Commercial. Next, tap the drop-down arrow to select the appropriate device classification.

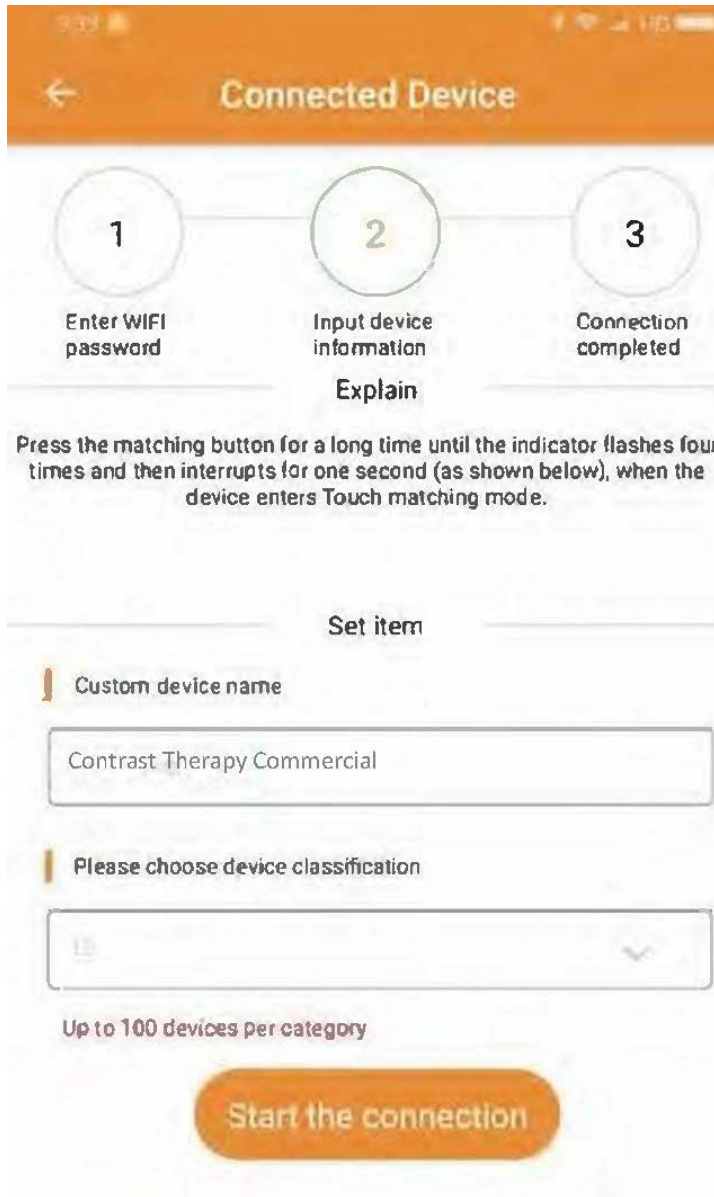

- Add a **new classification**; the name may be **customized** as needed.

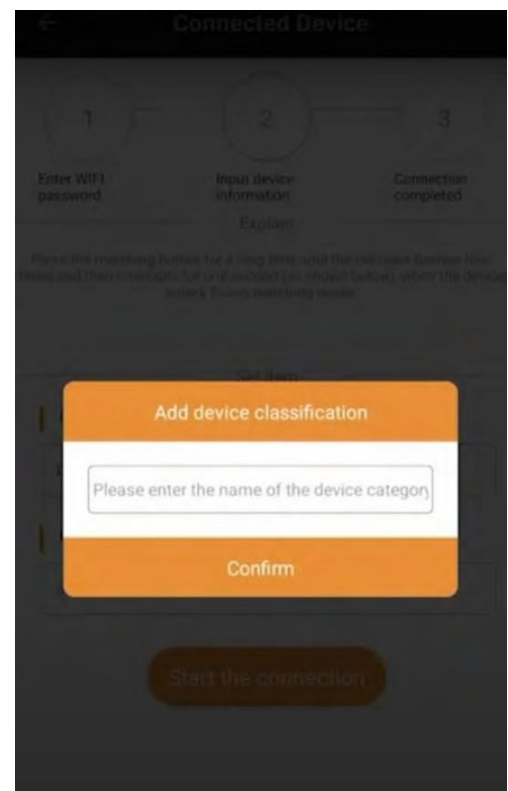
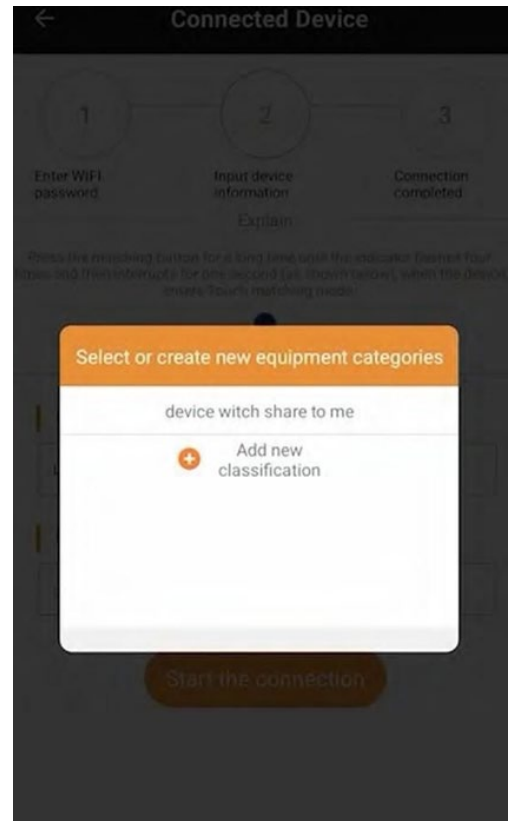

10. Copy the **password**, then go to your **smart device's Wi-Fi settings**.

NOTE: Do not press "Verify that the indicator flashes correctly."



11. Open your smart device's **Wi-Fi settings menu**, then go to the **Contrast Therapy Commercial Chiller control panel** then press and hold the **up and down arrow buttons** for at least 5 seconds. You will see "SinilinkProduct" appear in the network selection.



- 12. Select "SinilinkProduct" from the Wi-Fi network list. When prompted for a password, paste the password you copied from Step 10 (12345678).



- 13. Once connected to the SinilinkProduct network, exit the Wi-Fi settings on your smart device and return to the Sinilink app. The connection should start immediately.

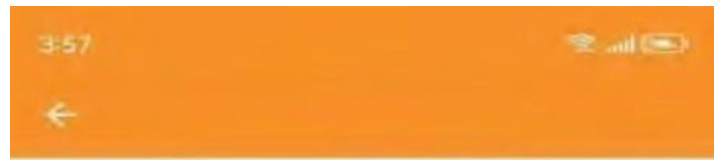

14. Once you have successfully added your **Contrast Therapy Commercial**, you will see the screen below. Select **"Back to Home Page"** to complete the set up.

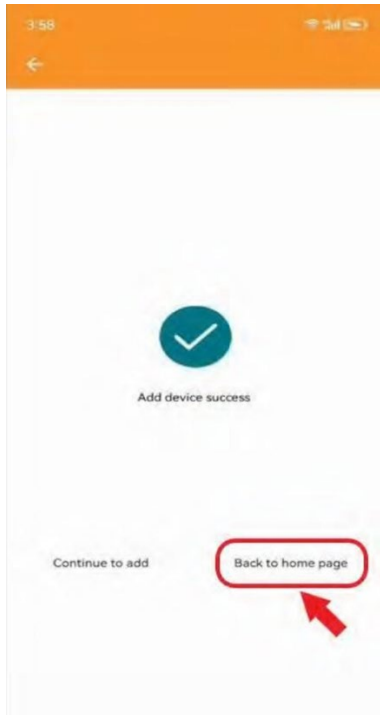

15. Tap on the screen area where it says **"Control"** to access the device controls.



16. The **operation interface** of the app will now appear, giving you full control of your **Contrast Therapy Commercial Chiller from your smart device**.

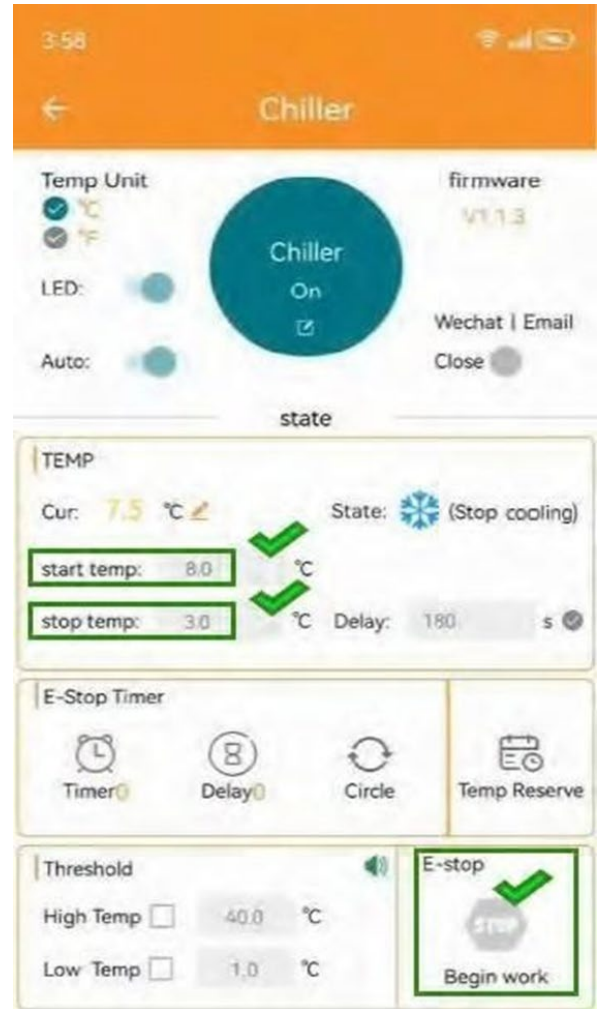

The cooling unit turns on when the current temperature is greater than or equal to the start temperature and turns off when the current temperature is less than or equal to the stop temperature. The Emergency Stop button is used to pause the Contrast Therapy Commercial chiller.

NOTE: Please refrain from modifying any parameters other than the three with check mark above (start temp, stop temp, compressor emergency OFF). Improper adjustments of other values may cause the chiller to malfunction.

CONTRAST THERAPY COMMERCIAL CHILLER TROUBLESHOOTING GUIDE

If your chiller is not operating properly, follow the steps below to diagnose and resolve common issues. Regular maintenance and proper set up are essential to ensuring optimal performance.

ISSUE	POSSIBLE CAUSE	RECOMMENDED SOLUTION
Low Water Flow / Weak Discharge	<ul style="list-style-type: none"> • Pipe may be bent or kinked • Filter element may be clogged 	<ul style="list-style-type: none"> • Inspect all hoses for bends or blockages • Replace the filter element
Abnormal Compressor Noise or Vibration	<ul style="list-style-type: none"> • Incorrect input voltage • Poor ventilation • Water temperature exceeds 38°C • Ambient air temperature above 32°C • Fan malfunction or reduced airflow 	<ul style="list-style-type: none"> • Check and correct input voltage • Ensure chiller has proper ventilation • Lower water temp below 38°C • Improve ambient airflow • Verify fan is operating normally
Slow or Not Cooling	<ul style="list-style-type: none"> • Incorrect input voltage • Poor ventilation • Fan blowing hot air onto tub • Ambient air is too hot (>32°C) • Poor tub insulation or lid not used • Fan airflow significantly reduced 	<ul style="list-style-type: none"> • Confirm input voltage • Improve chiller ventilation • Redirect fan away from tub • Reduce surrounding air temperature • Use insulated lid properly • Check fan functionality
Display Screen Not Turning On	<ul style="list-style-type: none"> • Power cord not connected • Incorrect input voltage • SA30 controller cable loose 	<ul style="list-style-type: none"> • Ensure power is connected • Verify input voltage • Open unit and check TSC power cable
Abnormal Temperature Display	<ul style="list-style-type: none"> • External heat source near water line • Uneven water temperature • Poor contact on thermometer signal wire 	<ul style="list-style-type: none"> • Remove heat sources near pipe • Stir water to even out temperature • Check signal cable connection on TSC
Incorrect High/Low Temperature Alarm (Real Temp Between 1–42°C)	<ul style="list-style-type: none"> • App temperature alarm values incorrectly set • Thermometer error (see issue #5) 	<ul style="list-style-type: none"> • Adjust app alarm settings • Recheck temp sensor and connections
Circulation Pump Not Working	<ul style="list-style-type: none"> • No power to pump • Pump transformer not outputting 24V DC • Faulty pump 	<ul style="list-style-type: none"> • Test voltage at pump power source • Verify 24V DC output from transformer • Replace pump if both above • are normal
Screen is On, but Compressor and Fan Never Start (over 3mins)	<ul style="list-style-type: none"> • No voltage to chiller • Loose wire between TSC and compressor 	<ul style="list-style-type: none"> • Confirm chiller is receiving power • Open case and secure TSC wiring or compressor wiring

CHILLER NOT TURNING ON**1. Check Power Supply**

- Ensure the chiller is plugged into a working outlet.
- Verify the GFCI/GCD plug is not tripped.

2. Inspect Circuit Breaker

- If tripped, reset it and try again.

CHILLER NOT COOLING**1. Verify Controller Status**

- Check if the LCD display has power.
- Ensure the LED/Working Light symbol is lit on the controller.
- If not, check the controller settings to confirm it is calling for cooling.

2. Compressor Functionality

- Ensure the compressor turns on and the controller readout remains steady.

3. Check Airflow

- Confirm airflow from the right side of the chiller is unobstructed.
- Check for clogs in the coil or blockages in ventilation.

4. Assess Air Temperature

- If warm air is coming from the right side, the chiller is at least partially cooling.
- If air is room temperature, further troubleshooting is needed.

5. Verify Water Temperature

- Use an external thermometer (not an IR gun) to check actual water temperature.
- Compare readings from:
 - Ambient air temperature
 - Chiller display reading
 - External thermometer measurement
- Clearly identifying temperature sources is crucial for accurate troubleshooting.

6. Ambient Temperature Consideration

- High room temperature can reduce cooling efficiency. Relocate the chiller to a cooler area if possible.

NO WATER FLOW BACK INTO TUB OR TANK**1. Check for Blockages**

- Ensure the filter is clean and not restricting water flow.
- If there is a valve on the tub drain, make sure it is fully open.

2. Perform Gravity Flow Test

(Ensure the chiller is unplugged for at least 30 minutes before performing this test.)

- Remove the filter from its housing and reattach the housing without the filter.
- Disconnect the inlet fitting – verify strong gravity-fed water flow. Reconnect the fitting.
- Disconnect the outlet fitting – ensure good gravity flow before reconnecting.
- Disconnect the filter connection fitting, lower the tubing, and check for water flow.
- Plug the chiller back in, observe water flow increase, and reconnect the fitting.

3. Backflush the System (If water flow issues persist)

- Remove the tubing from the outlet of the chiller.
- Use a garden hose to flush the system backwards through the outlet.
- Continue flushing for 15-30 seconds until air bubbles stop appearing in the tub.
- Reconnect the tubing, turn on the chiller, and check for restored water flow.

4. Identify Flow Obstructions

- If water is not flowing at any step, determine where the blockage occurs (inlet, outlet, filter hose, etc).

PUMP CIRCULATION ISSUES**1. Check Hose Connection**

- Ensure the hose from the ice bath is securely attached to the pump.
- Look for kinks, loose connections, or blockages restricting flow.

2. Ensure Proper Positioning

- The water level in the ice bath should be higher than the chiller's inlet.
- This allows gravity to assist water flow and prevent air pockets.

3. Prime the Pump

- If the pump is not pulling water, disconnect it, fill it with water, then reconnect.
- This removes trapped air and restores proper function.

4. Restart the System

- Turn off the chiller and pump, wait a few minutes, then restart them.
- This can help reset internal components and clear minor issues.

5. Inspect for Obstructions

- Check the pump's intake for debris or clogs hindering flow.
- Ensure the filter assembly is clean and free of air pockets.

6. Still Not Working?

- If circulation issues persist, contact your seller for assistance.
- Provide a video of your set up and describe the issue in detail.

OTHER COMMON ISSUES**1. Unusual Noises**

- Check for obstructions in vents and fans.
- Secure loose components to prevent rattling.

2. Water Leakage

- Ensure all hoses and fittings are securely connected.
- Inspect for cracks or damage causing leaks.

3. Error Messages on Display

- Refer to the user manual for specific error codes.
- Reset the chiller by turning it off, waiting a few minutes, and restarting.

4. Chiller Overheating

- Ensure proper ventilation and avoid placing the chiller in a confined space.
- Monitor ambient temperature, as excessive heat can cause overheating.

GLOSSARY OF TERMS



CONTROL PANEL: Mounted on the front side of the spa and controls the functions of the hot side.



CONTROL BOX (PACK): Basically the "heart" of the hot side. Power is distributed to any/all functions of the hot side: pumps, ozonator, LED lighting, heater element, etc.



CHILLER: This the "heart" of the cold side. It controls how cold the water gets and circulates the water.



SAND FILTER: A water filtration system that uses a bed of specially graded sand to remove impurities and debris from water. As water passes through the sand media, particles are trapped, ensuring clean and clear water.



EQUIPMENT ENCLOSURE: An enclosure that houses the control box, pump(s), filters and other electrical components.



KNIFE VALVES: A white "T"-handled valve used while servicing the spa equipment, the valves open or close the water flow to the equipment.



CHILLER WATER PUMP: Electrically powered pump designed to circulate water through a chiller system, ensuring efficient cooling.



PUMP PREFILTER/STRAINER: A device installed before the pump to capture debris and prevent clogging, improving pump performance and longevity.



BALL VALVE: A type of shut-off valve that controls water flow using a rotating ball inside the valve body.



DRAIN VALVE: A device used to release water from the Contrast Therapy for maintenance or winterization.



HEATER: The electronically controlled heater raises the temperature of the spa to the desired setting.



SKIMMER: This is the rectangular outlet at the water level. The skimmer removes surface debris to the filter. The water level in the spa should be kept $\frac{1}{2}$ to $\frac{3}{4}$ up on the skimmer for optimum operation.



FLOOR DRAIN: The floor drain is covered by a grate type cover and is utilized when draining the spa. It also acts as the return for the ozonator.



SUCTION: During operation of the equipment, the suction works in conjunction with the skimmer to draw water at up to 128gpm from the bottom of the spa through the filter, keeping the spa sparkling clean.



FLOOR DRAIN: The floor drain is covered by a grate-type cover and is utilized when draining the Contrast Therapy.



GFCI BOX: 15A GFCI Receptacle (Extra-Duty In-Use Weather Protection): A ground fault circuit interrupter (GFCI) designed to work outdoors or in damp environments.



CHILLER CONTROL PANEL: The user interface for adjusting and monitoring the cold side chiller unit's temperature and operational settings.



POWER SWITCH: A rocker-style switch that controls the power supply to the chiller unit, that tilts between two positions, typically labeled "I" (On) and "O" (Off). Turning the cold side chiller on or off.

DISCLAIMER: The pictures displayed above are for reference purpose only. Some parts may be different depending upon the unit model.

CONTRAST THERAPY COMMERCIAL GENERAL LAYOUT (Your Contrast Therapy Commercial may look different)

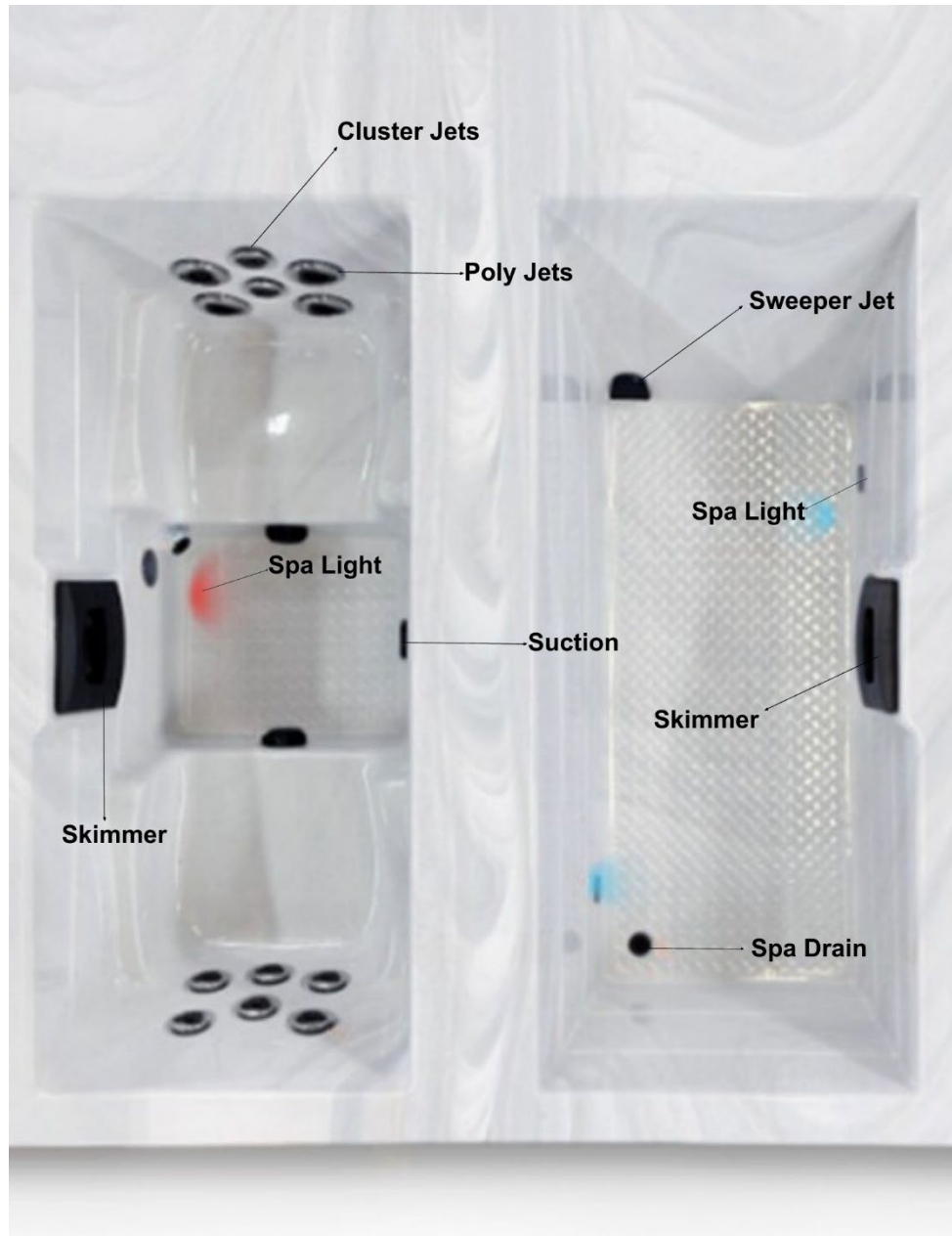

DISCLAIMER: The pictures displayed above are for reference purpose only. Some parts may be different depending upon the unit model.

DISCLAIMER: At the time of print, this manual is accurate in its information. Coast Spas reserves the rights to change or modify any unit designs and/or features without notification. To check on updates or for other information, please visit www.coastspas.com

CONTRAST THERAPY COMMERCIAL SPECIFICATION



Specification	Contrast Therapy
Dims (cms)	228.6cm x 228.6cm x 76.2 cm
Dims (in)	90" x 90" x 30"
Capacity (L)	954 L
Capacity (US gal)	252 gal
Dry Weight (kg)	223.6 kg
Dry Weight (lbs)	493 lbs
Wet Weight (kg)	1177.6 kg
Wet Weight (lbs)	2596.2 lbs
Electrical (V)	110V

CONTRAST THERAPY CARE GUIDE

Your authorized dealer carries a wide variety of care and maintenance products. For more information, please contact your Dealer.

SAND FILTER MAINTENANCE & REPLACEMENT

The sand filter system ensures crystal-clear water by trapping debris in a bed of No. 20-40 standard silica sand (particle size: 0.45–0.55 mm). Proper maintenance and periodic sand replacement are essential for optimal performance.

Routine Maintenance

Monitor Filter Pressure

- Record the clean filter pressure at initial start-up.
- When pressure rises 5–10 psi above the clean reading, backwash the filter.

Backwash Indicators

- Flow reduction by 30% from original clean flow.
- Pressure gauge increase of 10 psi over clean reading.
- Visible reduction in water flow from return jets.

Backwash Procedure

Multiport Valve Positions

1. Turn pump OFF before changing valve positions.
2. Set valve to BACKWASH, open suction and waste lines.
3. Start pump; backwash for 3–5 minutes or until water runs clear.
4. Stop pump; set valve to RINSE; run for 30 seconds.
5. Stop pump; set valve to FILTER; restart pump for normal operation.

Note: If pressure remains 4–6 psi higher after backwashing, perform a chemical cleaning of the sand bed.

CHANGING SAND FILTER

Filter Tank & Standpipe Assembly

Replace sand every 3–5 years or sooner if water clarity issues persist.

Steps:

1. Turn off power and drain the filter tank completely.
2. Remove the multiport valve and standpipe assembly.
3. Scoop out old sand and dispose of it safely.
4. Inspect and clean the underdrain assembly.
5. Add water to half-fill the tank (to cushion sand addition).
6. Pour in the correct amount of No. 20-40 silica sand.
7. Reinstall the standpipe and valve, ensuring proper alignment.
8. Tighten the clamp securely and check for leaks.

COVER CARE

A well cared for unit cover is a thing of beauty in its own right. Be sure to clean and condition your cover at least once a month (more often if needed).

WEATHERSHIELD COVER MAINTENANCE PROCEDURE

Weathershield is a solution dyed polyester fabric designed to be flexible and easy for manufacturers to use. Its urethane coating enhances the stability of the weaves and allows for greater water resistance, while also minimizing shrinkage and stretching. Weathershield features a high UV, water and mold and mildew resistance and have excellent tear and abrasion resistance.

CARE & CLEANING

Weathershield is designed to be easy to maintain. It can be washed or brushed off and rinsed. Proper care and cleaning are important to the life of all fabrics.

FOR NORMAL CARE AND CLEANING

- Add 2 ounces of mild soap such as Woolite or Dawn dishwashing liquid to 1 gallon of lukewarm water.
- Clean the fabric with a "soft bristle brush". Rinse thoroughly with cold water and dry air.

FOR STUBBORN STAINS

- Add maximum 1 cup of bleach to one 1 gallon of water.
- Spray on lightly to the fabric face (non-coated side). Do not soak fabric.
- Prolonged exposure to harsh chemicals can damage the coating.
- Rinse immediately. Do not leave on for more than 2 minutes.

Cleaning with harsh cleaners such as bleach will require re-treatment like 303 High Tech Fabric Guard for restoring water repellency.

! IMPORTANT NOTICE: DO NOT leave your unit drained and in direct sunlight for extended periods of time. Extreme heat could cause damage to the acrylic surface and may induce an effect known as "crazing". Crazing is not covered under spa limited warranty.

Public Health & Infection Control

Proper Contrast Therapy Commercial maintenance is essential to protect user health and prevent bacterial growth, including Legionella, Pseudomonas, and other harmful microorganisms. Failure to maintain clean, disinfected water can lead to serious illnesses such as Legionnaires' disease, folliculitis, ear or skin infections.

! KEY HEALTH RISKS

- Legionella bacteria can grow in warm water and aerosols, potentially causing Legionnaires' disease. ([CDC](#))
- Pseudomonas and other microorganisms can form biofilm in pipes and spa surfaces, causing skin, ear, or respiratory infections. ([CDC](#))
- Even clear water can harbor bacteria if not properly sanitized. ([Health Canada](#))

To minimize health risks:

- Sanitize water daily and maintain correct pH:
 - Free chlorine \geq 3 ppm
 - Bromine \geq 4 ppm
- Disinfect and shock-treat the water regularly following chemical manufacturer instructions.
- Drain, clean, and scrub the unit and components to remove biofilm and sediment.
- Clean and replace filters according to the maintenance schedule.
- Keep accurate water-testing logs, especially for commercial or multi-user units.
- Follow chemical dosing instructions carefully and maintain water balance daily.

! IMPORTANT NOTICE: Failure to maintain proper sanitation, chemical balance, and cleaning routines can create serious health risks and may void your warranty. Always follow the instructions in this manual and those from chemical suppliers.

For more information, refer to:

Health Canada: [Guidelines for Canadian Recreational Water Quality – Public Spa Pools](#)

Centers for Disease Control and Prevention (CDC): [Preventing Legionella in Hot Tubs and Spas](#)

Safety Signage for Contrast Therapy Commercial

For user safety, Coast Spas recommends placing a caution sign near the cold plunge:



⚠ CAUTION: Cold water immersion can cause cardiac stress. Exit immediately if you experience dizziness, shivering, or numbness.

This sign is intended to alert all users to potential risks and promote safe operation of the Contrast Therapy Commercial.

Skimmer Instructions

1. Use a clean skimming net to remove floating debris such as leaves, hair, or insects from the water surface.
2. Sweep the bottom of the tub to collect any settled particles.
3. Skim the water at least once per week, and ideally before each use.
4. For outdoor installations, skim more frequently during windy conditions or when nearby plants are shedding.
5. Always rinse the skimmer net after use and store it in a clean, dry location.

CHEMICAL HANDLING SAFETY

Proper handling of chemicals is essential to ensure safe operation and protect users from injury. Always follow manufacturer instructions and established safety standards when storing, mixing, or applying chemicals.

General Safety Guidelines

Personal Protective Equipment (PPE)

To ensure safety when handling chemicals:

- Always wear gloves and goggles.
- Avoid inhaling fumes. Use chemicals in a well-ventilated area.
- Avoid contact with skin, eyes, and clothing.
- Wash hands thoroughly after handling chemicals.

Mixing and Use Precautions

- **⚠ Never mix chlorine and acid.** This combination can create toxic gases that can cause severe injury or death.
- Always add chemicals to water, never water to chemicals.
- Use only Coast Spas approved sanitizers and water treatments.
- Carefully follow the dosage and application instructions provided by the chemical manufacturer.
- Do not use household cleaning agents in your unit.

Storage and Handling

- Store chemicals in their original containers with labels intact.
- Keep containers tightly closed when not in use.
- Store in a cool, dry, and well-ventilated area, away from direct sunlight and heat sources.
- Keep out of reach of children and pets.
- Store oxidizers and acids separately to prevent chemical reactions.

Spill and Exposure Response

- In the event of a chemical spill, clean immediately using non-reactive tools.
- Dispose of materials safely, according to local regulations.
- If chemicals contact skin or eyes, rinse immediately with clean water for at least 15 minutes and seek medical attention if irritation persists.
- If chemical fumes are inhaled, move to fresh air immediately and seek medical attention.

Regulatory Compliance

All chemical handling, storage, and disposal must comply with the following safety systems and standards:

- [WHMIS](#) (Canada)
- [OSHA](#) (USA)
- SDS/MSDS: Always refer to the Safety Data Sheet for each chemical used. This contains detailed instructions on hazards, handling, storage, and first aid.



CHEMICALS (CANADA)

Coast Spas chemicals play a vital role in ensuring the longevity, cleanliness, and overall enjoyment of your hot tub, swim spa & cold plunge experience.

For optimal performance and to ensure the longevity of your Coast Spas hot tub, swim spa & cold plunge, we strongly recommend using Coast Spas chemicals. Our specially formulated chemicals have been crafted with the utmost precision and care, utilizing premium-grade ingredients and formulations designed to complement the unique engineering of your Coast Spas products.

The use of alternative chemical products may lead to unintended chemical reactions, water imbalance, and possible damage to your spa's components. Moreover, it is important to note that failure to use Coast Spas chemicals may impact on your warranty coverage. To safeguard your investment and enjoy uninterrupted relaxation, trust in the quality and compatibility of Coast Spas chemicals – the ideal choice for your Coast Spas hot tub, swim spa & cold plunge.

**SCAN THIS QR TO
DOWNLOAD
BROCHURE**



HIGH QUALITY FORMULATION

Coast Spas hot tub, swim spa & cold plunge chemicals are designed by a team of experienced chemists who understand the unique needs of hot tubs, swim spa & cold plunge. They are formulated to provide optimal performance and reliability in Coast Spas hot tubs, swim spas & cold plunge ensuring that customers can enjoy their hot tubs, swim spas & cold plunge for longer periods of time.

EASY TO USE

Coast Spas chemicals are designed to be easy to use and require minimal effort to maintain. This means that customers can spend less time worrying about maintaining their hot tubs, swim spa & cold plunge and more time enjoying them.

RELIABLE AND EFFICIENT

Coast Spas chemicals are safe and effective, providing superior user experience for customers. They are designed to work seamlessly with Coast Spas hot tubs, swim spa & cold plunge, ensuring that customers can enjoy their hot tubs, swim spa & cold plunge without any issues.



CHEMICALS (USA)

Coast Spas®

Coast Spas chemicals play a vital role in ensuring the longevity, cleanliness, and overall enjoyment of your hot tub, swim spa or cold plunge experience.

For optimal performance and to ensure the longevity of your Coast Spas hot tub, swim spa & cold plunge, we strongly recommend using Coast Spas chemicals. Our specially formulated chemicals have been crafted with the utmost precision and care, utilizing premium-grade ingredients and formulations designed to complement the unique engineering of your Coast Spas hot tub, swim spas & cold plunge.

The use of alternative chemical products may lead to unintended chemical reactions, water imbalance, and possible damage to your spa's components. It is important to note that failure to use Coast Spas chemicals may impact on your warranty coverage. To safeguard your investment and enjoy uninterrupted relaxation, trust in the quality and compatibility of Coast Spas chemicals — the ideal choice for your Coast Spas hot tub, swim spas & cold plunge.



HIGH QUALITY FORMULATION

Coast Spas chemicals are designed to be easy to use and require minimal effort to maintain. This means that customers can spend less time worrying about maintaining their hot tubs, swim spas & cold plunge and more time enjoying them.

EASY TO USE

Coast Spas chemicals are safe and effective, providing superior user experience for customers. They are designed to work seamlessly with Coast Spas hot tubs, swim spas & cold plunge, ensuring that customers can enjoy their hot tubs, swim spa & cold plunge without any issues.

RELIABLE AND EFFICIENT

Coast Spas chemicals are safe and effective, providing superior user experience for customers. They are designed to work seamlessly with Coast Spas hot tubs, swim spa & cold plunge, ensuring that customers can enjoy their hot tubs, swim spa & cold plunge without any issues.

SCAN THIS QR
TO DOWNLOAD
BROCHURE



Contrast Therapy Commercial

Chemical Safety Guidelines

Before installing or operating your Contrast Therapy Commercial, carefully review all chemical safety instructions, operational precautions, and warranty information to ensure safe and proper use.

Chemical Safety

Muriatic Acid & Liquid Chlorine Information

The following chemicals are recommended for use with the Contrast Therapy Commercial:

- Muriatic Acid (14.5% Hydrochloric Acid)
- Liquid Pool Chlorine (10% Sodium Hypochlorite)

Refer to the Safety Data Sheets (SDS) for detailed handling instructions:

- [HDX Muriatic Acid SDS](#)
- [Acid Blue Muriatic Acid SDS](#)
- [HDX Liquid Pool Chlorine SDS](#)

Water Chemistry Guidelines

- Always review chemical handling instructions, SDS documents, and warning labels on chemical reservoirs before adding any chemicals.
- For the Auto Doser system:
 - Chlorine: Use Liquid Chlorine (10–12.5% Sodium Hypochlorite)
 - pH Down: Use Swimming Pool Muriatic Acid Balancer (14.5% Hydrochloric Acid)
- Add only the correct chemical to its designated reservoir. Never mix chemicals or add powdered/diluted chemicals.
- Use only recommended chemicals. Substitutions or higher concentrations may damage the system and void the warranty.
- After set up, allow the Auto Doser to cycle for 24 hours before use to stabilize water chemistry.
- Encourage all users to shower prior to use to maintain proper water balance.
- Outdoor use may reduce chemical lifespan due to UV exposure and environmental debris.
- Do not use untreated well water. If on well water, properly filter it using an ion exchange system before filling the plunge.
- The system is calibrated for cold water only; do not exceed recommended water parameters.

Auto Doser Probe Instructions

- The probe ships in a wet storage solution. Ensure it does not dry for more than 15 minutes, or readings may fail.
- If storing the plunge, remove the probe and return it to its storage cap with solution. Contact technicalsupport@coastspas.com for guidance.
- The silver probe wrench included in the Auto Doser Starter Kit is used to install and remove the probe.

Auto Doser Controller Overview

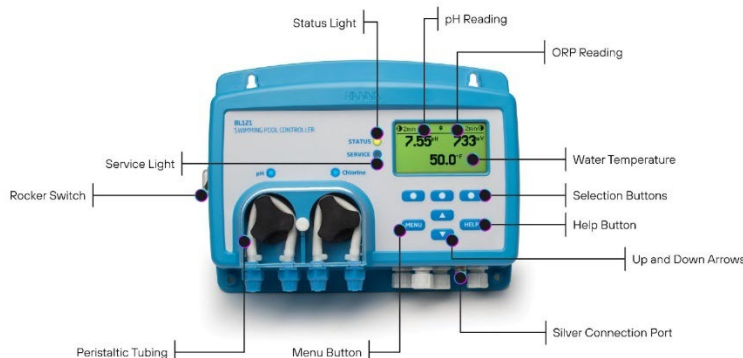

- **pH Reading:** Maintains ~7.35 pH (acceptable range 7.1–7.5). To raise pH, use a recommended pH increaser. Always test water before adding chemicals.
- **ORP Reading:** Measures the water's ability to sanitize itself. Target ~735 mV (range 690–875 mV).
- **Water Temperature:** Displays the current water temperature in °F.
- **Status Light:** Blinks yellow/red if probe readings are outside the acceptable range. Press Help for details.
- **Service Light:** Blinks yellow/red when maintenance is required. Press Help for instructions.
- **Help Button:** Shows active error codes and guidance.
- **Menu Button:** Access set up mode, manual pump controls, and pH/ORP/temperature settings.
- **Arrow & Selection Buttons:** Navigate the menu and adjust settings.
- **Silver Connection Port:** Connects the Auto Doser probe.
- **Peristaltic Tubing:** Transfers chemicals from reservoirs into the plunge.
- **Power Rocker Switch:** Turns the Auto Doser controller on/off.

Contrast Therapy Commercial Set Up Guide

Step 1: Choosing a Safe Location

⚠ WARNING: Risk of Electric Shock.

Install your Contrast Therapy Commercial at least 1.5 meters (5 feet) away from electrical outlets, appliances, or other sources of electricity.

Placement Guidelines:

- Set the plunge on a solid, level, and waterproof surface.
- Ensure at least 16 inches of clearance along the side housing components for proper ventilation.
- Maintain a minimum of 24 inches of space on the equipment side for maintenance access.

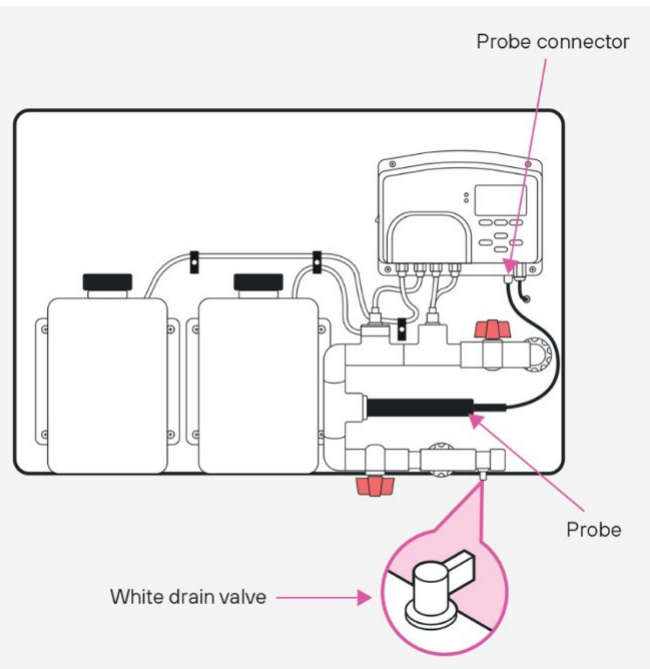

Step 2: Filling the Plunge

- Connect a water filter to a garden hose.
- Run water through the filter and into a drain until it runs clear of debris.
- Fill the Contrast Therapy Commercial with filtered water.
- Water should reach halfway up the skimmer to ensure proper circulation.

Step 3: Installing the Probe

- The probe cap contains a saline solution to keep it moist. Hold the probe vertically with the cap down when removing it to prevent spills.
- Some salt residue on the cap is normal. If the inside of the cap is dry, the probe may require recalibration.
- Keep the cap safe for future storage; the solution does not need to be saved.
- Insert the probe into the marked location and secure it with the provided silver probe wrench.
- Open the two-colored ball valves (turn handles parallel to the tubing). Ensure the white drain valve remains closed and capped.
- Check the probe wire is untwisted and connect the silver probe connector to the Auto Doser's bottom-right port. Hand-tighten the collar to secure.

⚠ IMPORTANT: The probe must not be left dry for more than 15 minutes to avoid damage.

Step 4: Adding Chemicals to the Auto Doser

- Each reservoir is labeled for a specific chemical. Only add the correct chemical to the corresponding reservoir. Do not mix chemicals.
- Remove the caps and locate the MIN and MAX fill lines.
- For the initial filling, add chemical just above the MIN line.
- Replace and tighten caps securely.
- After the Contrast Therapy Commercial has run for 24 hours, fill each reservoir up to the MAX line.

Recommended Chemicals:

- Swimming Pool Muriatic Acid Balancer (14.5% Hydrochloric Acid)
- Liquid Chlorine (10–12.5% Sodium Hypochlorite)

⚠ SAFETY NOTICE: Always read the Chemical Safety Data Sheets (SDS) and follow proper handling instructions before adding chemicals.

⚠ IMPORTANT: For spas or hot tubs installed indoors, care should be taken to ensure adequate ventilation for the indoor space to avoid undesired buildup of humidity due to spa water. For additional information on ventilation and humidity guidelines, see the ASHRAE Handbook – HVAC Applications, I-P Edition, Sections 4.5, 4.6, and 4.7.

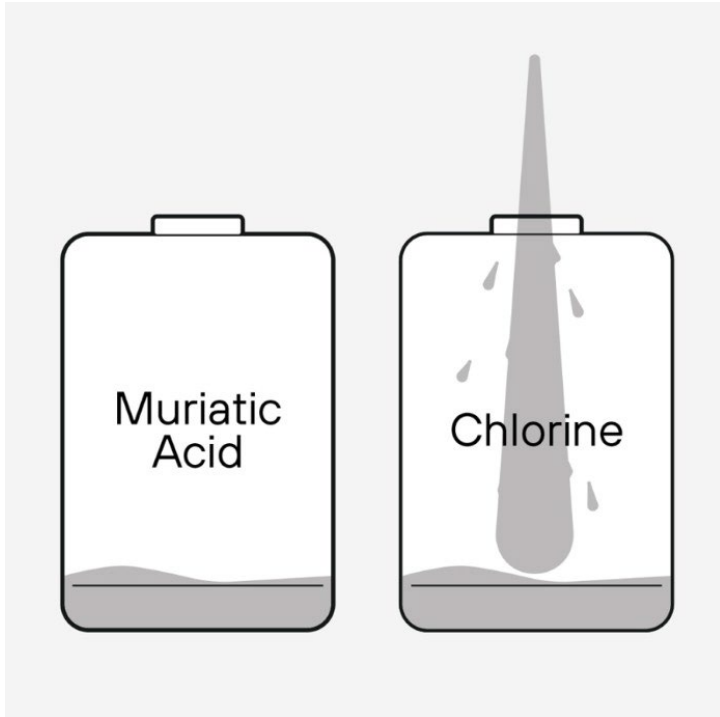

Proper maintenance extends the life and functionality of the Contrast Therapy Commercial. Not following the maintenance instructions will void the warranty. For any questions, please email us at technicalsupport@coastspas.com

Warranty & Maintenance

- Damage caused by freezing temperatures or improper water chemistry is not covered under warranty.
- Monitor your Contrast Therapy Commercial closely when temperatures approach 32°F / 0°C. If ambient temperatures stay below freezing for 12 hours, drain and winterize the plunge, filter, and chiller.
- The Contrast Therapy Commercial should operate continuously (24/7). Stagnant water can cause unsanitary conditions and buildup inside pipes. Follow the cleaning and maintenance protocols in this manual.
- Extension cords: Use a 12-gauge cord (up to 25 feet) if needed and follow local electrical codes. Outdoor cords must be protected with a weatherproof connection box.
- For additional support, contact technicalsupport@coastspas.com or submit a ticket through our website: www.coastspas.com.

IMPORTANT NOTICE

- Flooring: Ensure the installation surface waterproof/resistant to prevent damage.
- Power: Do not energize the system until the plunge is filled to the required level. Running the pump dry can cause immediate damage and void the warranty.
- Deck Installation: Confirm that your deck can safely support the filled plunge. Consult a qualified contractor or structural engineer. The filled plunge weighs 2596.2 lbs/1177.6 kg.
- Water Chemistry: Follow the manual's water chemistry guidelines. Improper chemical balance can damage the system or cause skin irritation.

Step 5: Connecting to Power

- Allow the Contrast Therapy Commercial to rest for at least 20 minutes after moving to let the coolant settle.
- Plug the unit into a dedicated 110V-120V, 15A circuit. Do not use a circuit shared with other appliances.
- Ensure the outlet is at least 5 feet away from any body of water.

Step 6: Powering On the Contrast Therapy Commercial

- Locate the "Test" and "Reset" buttons on the power cord.
- Press "Reset" to turn on the cold plunge.
- The jets should activate, and the LED display on the chiller will show the current water temperature.

Step 7: Setting the Temperature

- Use the chiller's controls to select your desired water temperature.

Step 8: Water Maintenance

- Balance the water before allowing any use. Proper chemical balance ensures safety and prolongs equipment life.
- Test and adjust water chemistry according to instructions.

⚠ Do not skip water testing and balancing.

Unbalanced water can damage the system and void the warranty.

Contrast Therapy Commercial Water Care Guide

We're thrilled you're enjoying your Contrast Therapy Commercial! Proper care keeps your plunge operating efficiently, water clean and safe, and ensures your warranty remains valid. Regular maintenance also extends the life of your unit and helps avoid costly repairs.

Note: These are minimum recommended intervals. Units with high usage (more than 20 plunges per day) may require more frequent maintenance.

IMPORTANT: The spa or swim spa water shall be tested and treated in accordance with applicable local codes. For Pool and Hot Tub Water Sanitation, see [Uniform Swimming Pool, Spa and Hot Tub Code](#), Chapter 5 – Water Quality.

Daily Care

- Skim the water to remove leaves, hair, or debris.
- Clear debris from drain strainers.
- Wipe the waterline to remove any surface film or buildup.
- Test water chemistry daily and adjust as needed using the Contrast Therapy Commercial Water Maintenance Protocol.

Every Two Days – Skimmer Maintenance

Cleaning Your Skimmer:

1. Open the skimmer housing by gently pulling it forward.
2. Remove the basket and empty all debris. Rinse thoroughly under running water.
3. Replace the basket and close the skimmer housing.

Tip: Keeping the skimmer clean ensures proper water circulation and helps maintain optimal water quality.

Weekly – Filter Maintenance

Replacing the Filter:

1. Confirm your plunge is connected to the Smart Life app.
2. Pause the unit using the UI and ensure no jets are running.
3. Remove the filter housing cover by pressing gently or using the provided filter wrench if needed.
4. Take out the old filter and remove any loose debris from the housing.
5. Insert a clean filter, ensuring it sits correctly: Properly seated – Filter stands straight and does not touch the housing walls. The bottom nodule fits into the center hole. Improperly seated – Filter leans or touches the housing walls.

6. Verify the o-ring is seated and free of debris before replacing the cover. Hand-tightening only; over-tightening can damage threads.

Tip: A clean filter keeps water flowing efficiently and protects the system from damage.

Every Four Weeks – Water Replacement & Drain Strainers

Draining and Refilling:

1. Pause the plunge and wait for jets to stop.
2. Turn off the unit completely (unplug or press the “test” button).
3. Remove the ventilation screen opposite the filter housing.
4. Remove the spigot cap and attach a garden hose to drain water. Drain speed may vary with hose length and elevation.
5. Replace the cap after draining.

Cleaning Drain Strainers:

6. Drain the plunge completely.
7. Remove each strainer by unscrewing the small notches.
8. Clean thoroughly with a brush and use a pin to remove any stuck debris.
9. Reinstall the strainers, refill the plunge, and power it on.

Tip: Replacing water regularly keeps it clean, safe, and prevents long-term system wear.

Every Three Months – Ventilation Screen Maintenance

Cleaning the Screens:

1. Remove the ventilation screen by lifting from the bottom.
2. Rinse under running water to remove dust and debris.
3. Shake off excess water and allow the air to dry briefly.
4. Reinstall the screen by inserting the top lip first and pressing gently into place.

Tip: Clean screens maintain proper airflow and reduce dust accumulation in the system.

Every Six Months- Deep Cleaning

Items Needed: Household degreaser, sponge or cloth, jet cleaner, sanitizer, new filter

Step 1 – Jet Cleaning:

1. Turn off and drain the plunge completely.
2. Wipe down all surfaces with degreaser, then rinse thoroughly.
3. Refill the plunge with water 2 inches above the highest jet or drain. Add warm water if needed.
4. Replace the filter if it is 3–4 weeks old or visibly dirty.
5. Add the recommended jet cleaner to the water and run the system for 15 minutes at maximum temperature.
6. Pause the system for 1 hour, then run again for 15 minutes.
7. Drain and rinse the plunge thoroughly.

Step 2 – Sanitizing:

8. Refill the plunge to 2 inches above the highest jet or drain.
9. Turn the jets on and set the temperature to maximum.
10. Add the recommended sanitizer (do not mix different types).
11. Run the plunge for 20 minutes, then continue filling to full capacity while running.

Tip: A deep clean every six months removes buildup, protects the system, and keeps water safe for regular use.

Contrast Therapy Commercial Water Maintenance

To keep your Contrast Therapy Commercial water safe and clean, see below for a protocol we recommend. This is a protocol that we've seen work well in most situations. Please keep in mind that water chemistry can be different based on the quality of your water in your jurisdiction.

If you are on well water, please make sure you can properly reduce calcium levels before filling the tub. High amounts of calcium can damage the pump over time.

Poor water quality can lead to skin infections, ear infections, and urinary tract infections. That's why it's important to monitor and manage the quality of the water routinely.

These water maintenance instructions are meant to be used alongside the regular maintenance protocols for your Contrast Therapy Commercial. For more guidance, please email technicalsupport@coastspas.com.

Commercial Chlorine Water Maintenance Manual

To keep your Contrast Therapy Commercial water safe and clean in a commercial environment, see below for a protocol we recommend. This is a protocol that we've seen work well in most situations. Please keep in mind that water chemistry can be different based on the quality of your water in your county. If you are on well water, please make sure you can properly reduce calcium levels before filling the tub. High amounts of calcium can damage the pump over time. These water maintenance instructions are meant to be used alongside the regular maintenance protocols for your Contrast Therapy Commercial.

Products needed:**Coast Spas Chemical Starter Kit Includes:**

- Alkalinity Booster (100 g)
- Calcium Booster (100 g)
- Chlorine (100 g)
- pH down (100 g)
- pH Up (100 g)
- Stain & Scale (500 mL)
- Testing Kit

⚠ IMPORTANT: Wait 15 minutes between adding different chemicals. This helps them mix properly.

Follow these steps each time you drain and refill your plunge:

- Fill your Contrast Therapy Commercial with clean, fresh water.
- Test the water with your chlorine test strips to check alkalinity and pH.
- Adjust alkalinity first, then pH, following the guidelines in the tables provided.

Daily Water Care

Maintenance may need to be done more often if the plunge is heavily used.

1. Check the water daily using your chemical testing kit and adjust as needed.
2. Wipe the waterline with a sponge to remove any buildup.
3. Clean the drain strainers by removing hair or debris to keep water flowing smoothly.

Tip: Always wait at least 15 minutes between adding each chemical.

Chlorine Table

Please wait 1 hour before retesting and adding more chemicals.

Chlorine Reading	Add
0 - 1 PPM	2 Teaspoons of Replenish
2 PPM	1 Teaspoon of Replenish
3 - 5 PPM	Leave as is
Over 5 PPM	Add fresh water to the Plunge

Alkalinity Table

Please wait 1 hour before retesting and adding more chemicals.

Alkalinity Reading	Add
0 - 20	4 Tablespoons of Spa Up
21 - 40	3 Tablespoons of Spa Up
41 - 60	4 Teaspoons of Spa Up
61 - 80	1 Teaspoon of Spa Up
81 - 120	Leave as is
Above 120	Add 1 Tablespoon of Spa Down and let the water cycle for 1 hour. If it's still high, repeat.

We recommend adjusting and stabilizing Alkalinity first and then pH.

pH Table

Please wait 1 hour before retesting and adding more chemicals.

pH Reading	Add
Below 7.0	1 Tablespoon of Spa Up
7.0 - 7.1	2 Teaspoons of Spa Up
7.2 - 7.8	Leave as is
7.9 or above	Add 1 Tablespoon of Spa Down and let the water cycle for 1 hour. If it's still high, repeat.

Commercial Non-Chlorine Water Maintenance

To keep your Contrast Therapy Commercial water safe, clean, and refreshing in a commercial setting, follow the protocol below. This non-chlorine care routine has proven effective when performed consistently. However, chlorine-based systems can also be used if they better suit your facility's needs. If the water becomes cloudy or develops an odor, it's best to drain and refill the plunge with fresh water. If the plunge ever stops filtering or is turned off, be sure to empty the plunge, the filter, and the chiller. Still water can become unsanitary and may affect performance.

⚠ IMPORTANT: If water is not circulating, turn off the chiller immediately to prevent damage.

Key: Tbsp = Tablespoon | Tsp = Teaspoon

Initial Set up (After Each Drain and Refill)

Contrast Therapy Commercial:

1. Fill the plunge with clean, fresh water using a carbon hose filter if available.
2. Add 3 tablespoons of Coast Spas Alkalinity Booster to balance alkalinity.
3. Add 1 tablespoon of Coast Spas Non-Chlorine Sanitizer.
4. Add 6 tablespoons of 27% Hydrogen Peroxide (Coast Spas Oxidizer) to help oxidize and clarify the water.

Daily Water Care

1. Wipe down the plunge surface and clean the drain covers using a soft sponge.
2. Test Hydrogen Peroxide levels using your provided test kit.
3. Add 27% Hydrogen Peroxide (Coast Spas Oxidizer) as needed based on your readings, ideally once in the morning and once at the end of the day.
4. Check and adjust sanitizer, pH, and alkalinity levels according to your test results.

Note: Consistent daily care helps maintain crystal-clear water, protects internal components, and ensures a safe experience for every user.

1. Hydrogen Peroxide (H₂O₂) Levels

Use 27% Hydrogen Peroxide Solution as your primary oxidizer. Check H₂O₂ levels regularly and adjust according to the chart below.

Hydrogen Peroxide (PPM)	Amount of 27% H ₂ O ₂ to Add
0–20 PPM	8 Tbsp
21–40 PPM	7 Tbsp
41–60 PPM	5 Tbsp
61–80 PPM	4 Tbsp
81–100 PPM	3 Tbsp
101+ PPM	No addition required

Note: Allow water to circulate for at least 30 minutes after adding hydrogen peroxide before retesting levels.

2. Sanitizer Levels

Maintain sanitizer levels using Coast Spa Sanitizer (non-chlorine) to ensure safe and clear water.

Sanitizer Reading (PPM)	Action
0 PPM	Add 4 tsp Coast Spa Sanitizer
15 PPM	Add 1 tsp Coast Spa Sanitizer
30–50 PPM	Leave as is
Over 50 PPM	Drain and refill with fresh water

Note: If sanitizer levels remain high after 24 hours, consider partial water replacement to restore balance.

3. pH Balance

The ideal pH range for the Contrast Therapy Commercial is 7.2 to 7.8.

Maintaining this range prevents corrosion, scale formation, and skin irritation.

pH Reading	Action
7.0 or below	Add 1 Tbsp Coast Spa Up
7.2–7.3	Add 2 tsp Coast Spa Up
7.4–7.9	Leave as is
8.0 or above	Use Coast Spa Down

⚠ IMPORTANT: Always adjust alkalinity first before correcting pH levels.

4. Total Alkalinity

Total alkalinity stabilizes pH and prevents erratic water chemistry.

Target range: 80–120 PPM

Alkalinity Reading (PPM)	Action
0–20	Add 4 Tbsp Coast Spa Up
21–40	Add 3 Tbsp Coast Spa Up
41–60	Add 1 Tbsp Coast Spa Up
61–80	Add 1 tsp Coast Spa Up
81–120	Leave as is
180 or above	Use Coast Spa Down

WATER CLARITY TROUBLESHOOTING

PROBLEM	PROBABLE CAUSE	POTENTIAL SOLUTIONS
Water Odor	<ul style="list-style-type: none"> <input type="checkbox"/> Improper sanitization <input type="checkbox"/> Excessive organics in water <input type="checkbox"/> pH is too low 	<ul style="list-style-type: none"> <input type="checkbox"/> Add sanitizer <input type="checkbox"/> Shock unit with sanitizer <input type="checkbox"/> Adjust pH
Chlorine Odor	<ul style="list-style-type: none"> <input type="checkbox"/> Chloramines are too high <input type="checkbox"/> pH is too low 	<ul style="list-style-type: none"> <input type="checkbox"/> Shock unit with sanitizer <input type="checkbox"/> Adjust pH
Musty Odor	<ul style="list-style-type: none"> <input type="checkbox"/> Bacteria or Algae growth 	<ul style="list-style-type: none"> <input type="checkbox"/> Shock unit with sanitizer <input type="checkbox"/> Drain and refill unit water
Scale	<ul style="list-style-type: none"> <input type="checkbox"/> Total alkalinity is too high <input type="checkbox"/> pH is too high <input type="checkbox"/> High calcium content in water 	<ul style="list-style-type: none"> <input type="checkbox"/> Adjust total alkalinity <input type="checkbox"/> Adjust pH <input type="checkbox"/> Use stain and scale product
Stain	<ul style="list-style-type: none"> <input type="checkbox"/> Total alkalinity is too low <input type="checkbox"/> pH is too low <input type="checkbox"/> High metal content in water 	<ul style="list-style-type: none"> <input type="checkbox"/> Adjust alkalinity <input type="checkbox"/> Adjust pH <input type="checkbox"/> Use stain and scale product
Cloudy Water	<ul style="list-style-type: none"> <input type="checkbox"/> Poor filtration <input type="checkbox"/> pH is too high <input type="checkbox"/> Hardness is too high <input type="checkbox"/> Total alkalinity is too high <input type="checkbox"/> Suspended particles 	<ul style="list-style-type: none"> <input type="checkbox"/> Clean filter <input type="checkbox"/> Adjust pH <input type="checkbox"/> Adjust hardness <input type="checkbox"/> Adjust total alkalinity <input type="checkbox"/> Drain and refill unit water
Algae Growth	<ul style="list-style-type: none"> <input type="checkbox"/> pH is too high <input type="checkbox"/> Sanitizer is too low 	<ul style="list-style-type: none"> <input type="checkbox"/> Adjust pH <input type="checkbox"/> Shock unit with sanitizer <input type="checkbox"/> Adjust sanitizer level
Eye Irritation	<ul style="list-style-type: none"> <input type="checkbox"/> pH is too low <input type="checkbox"/> Sanitizer is too low 	<ul style="list-style-type: none"> <input type="checkbox"/> Adjust pH <input type="checkbox"/> Shock unit with sanitizer <input type="checkbox"/> Adjust sanitizer level
Skin Rash/Irritation	<ul style="list-style-type: none"> <input type="checkbox"/> Free chlorine level too high <input type="checkbox"/> Unsanitary water 	<ul style="list-style-type: none"> <input type="checkbox"/> Adjust chlorine level <input type="checkbox"/> Shock unit with sanitizer <input type="checkbox"/> Adjust sanitizer level

DRAINING AND WINTERIZING

The Contrast Therapy Commercial is designed to withstand various weather conditions but is not rated for freezing temperatures. If the temperatures in the area drop to 32°F (0°C) or lower, you must winterize the unit to prevent damage.

If the temperature is expected to stay below freezing for more than 12 hours, follow these steps to properly store and protect your Cold Plunge system:

STEP BY STEP DRAINING AND WINTERIZATION PROCESS

Cold Side – Draining & Winterizing (Sand Filter System)

1. **Power Down:** Turn off the chiller and pump, then unplug from the power source.
2. **Drain the Water:** Open the drain valve and attach a hose to direct water away. Use a shop vac to remove residual water from plumbing and jets.
3. **Sand Filter Care:**
 - Turn off the pump and set the multiport valve to WINTERIZE or remove the drain plug at the bottom of the filter tank.
 - Allow all water to drain completely.
 - Remove the multiport valve and store it indoors to protect seals and gaskets.
 - Leave the tank open and the drain plug off to prevent trapped water from freezing.
4. **Disconnect & Store:** Remove hoses, clean the filter area, and store components (valve, hoses) in a frost-free location.
5. **Final Prep:** Wipe down the tub interior, cover the unit loosely for ventilation, and ensure no standing water remains in plumbing or filter housing.

Hot Side – Draining & Winterizing

1. **Turn Off Power:** Shut down the spa pack and disconnect power at the breaker.
2. **Drain Tub:** Open the drain spigot and attach a hose to empty water completely. Use a shop vac for residual water in jets and plumbing.
3. **Remove Filters:** Take out filter cartridges, clean or discard, and dry the housing.
4. **Protect Equipment:** Blow out lines, if possible, clean the shell, and secure the cover. For extended freezing conditions, add RV antifreeze to plumbing if recommended.

By following these steps, you can prevent damage and extend the lifespan of your Contrast Therapy Commercial, ensuring it remains in optimal condition for future use.

⚠ WARNING: Always follow proper winterization steps and ensure your Contrast Therapy Commercial is prepared correctly for freezing conditions

⚠ IMPORTANT WARRANTY INFORMATION: Please be aware that damage caused by freezing temperatures or improper water chemistry is not covered under the warranty.

Cold Weather Monitoring & Winterization

When outdoor temperatures approach freezing (32°F / 0°C), monitor your Contrast Therapy Commercial daily to ensure proper flow. If temperatures remain below freezing for 12 hours or longer, you must fully drain and winterize the Contrast Therapy Commercial, including the filter housing and chiller, to prevent damage.

Liability and Safety Notice

LIABILITY DISCLAIMER: Coast Spas is not responsible for repairs or replacement of any damage that occurred due to the Contrast Therapy Commercial left in freezing conditions without being properly drained/ stored. Customer may contact selling dealer/ service provider for repairs, but any damage caused by freezing will not be covered under warranty.

ASSUMPTION OF RISK: By using your Contrast Therapy Commercial, you accept all risks related to its operation and maintenance. This includes the risk of injury, illness, or property damage that may result from improper use, poor water care, or not following the safety and maintenance instructions provided in this manual.

COMMERCIAL OPERATOR RESPONSIBILITIES

If your unit is used in a commercial or public setting, the facility owner or operator must:

- Test and record water quality daily.
- Maintain proper chemical balance as required by local health and safety regulations (e.g., BC Pool Regulations, CSA G22.2 No. 218); and
- Ensure that only trained personnel operate and maintain the unit.

Coast Spas' warranty and liability coverage apply only when the unit is used and maintained according to Coast Spas' instructions and by qualified technicians.

INDEMNIFICATION: By installing or operating this unit, the owner or operator agrees to protect and hold Coast Spas harmless from any claims, damage, or losses that result from misuse, unauthorized changes, or failure to maintain safe operating conditions.

THIRD PARTY EQUIPMENT DISCLAIMER: If any Third-party components (such as filters, chillers, dosing systems, or automation equipment) are added or modified by others; Coast Spas cannot be held responsible for any damage, malfunction, or injury that may result from those additions.

Winter Preparation Guide

Contrast Therapy Commercial

Proper winter preparation ensures peak performance and protects your Contrast Therapy Commercial from cold-weather damage. Follow the guidelines below to maintain safe, reliable operation throughout the winter season.

1. Maintain Clean and Efficient Filtration.

A clean filter ensures efficient water circulation and performance.

- Inspect the filter regularly for debris or buildup.
- Clean the filter housing or replace the filter cartridge as needed to maintain proper circulation.

2. Ensure Continuous Water Flow

Adequate water movement helps prevent freezing and system shutdown.

- Check flow daily to confirm a steady stream of water.
- If flow becomes restricted, troubleshoot immediately.
- If flow cannot be restored, fully drain and winterize the unit to prevent freezing damage.

3. Monitor Freezing Conditions

Cold temperatures can affect system performance.

- Stay aware of local weather conditions.
- If temperatures are forecast to drop below 32°F (0°C) for more than 12 hours, take preventative action.

4. Winter Operations Options

- **Using the unit:** Set water temperature to 50°F (10°C) or higher.
- **Not using the unit:** Fully drain and winterize according to the Owner's Manual.

5. Full Drain for Freeze Protection

If freezing temperatures persist:

- Fully drain the unit to prevent ice formation inside plumbing or equipment.
- Proper drainage ensures no residual water remains that could cause damage.

6. Severe Weather or Power Outage Preparation

- Drain the unit if a storm or outage is expected.
- Store chiller and filter indoors in a warm location.
- Follow Owner's Manual for detailed winterization instructions.

7. Extended Absence During Freezing Weather

- Drain and winterize if away for more than 24 hours in freezing conditions.
- Store components indoors to protect from extreme cold.

By following these winter maintenance steps, you can protect your Contrast Therapy Commercial from freezing conditions and ensure reliable performance throughout the winter season and beyond.

AUTO DOSING SYSTEM

Auto Dosing System Maintenance

The Automatic Dosing System is a built-in feature of the Contrast Therapy Commercial. It is designed to automate water care by monitoring and adjusting the levels of chlorine and pH, helping ensure water quality remains clean, safe, and compliant with health standards, especially in commercial or high-usage environments.

Accessing the System:

Locate the access door. It's discreetly tucked away to avoid becoming a tripping hazard. Remove the door, simply pull it off. No tools or force are required. It's held in place by magnets for easy access.

Chemical Containers

The System uses two chemical containers:

- One for chlorine
- One for pH+ (pH increaser)

Refilling Chemicals

1. Remove the chemical bottle from the system.
2. Take off the tap and protective cap.
3. Refill with the appropriate chemical.

⚠ IMPORTANT: Never mix chlorine and pH+ chemicals, as this can create a hazardous reaction.

4. Replace the cap securely.
5. Return the bottle to its slot in the system.
6. Close the access panel.

⚠ IMPORTANT: Regularly check chemical levels and refill as needed.

⚠ IMPORTANT: Inspect sensors periodically for debris or scaling. Clean gently with soft cloth if necessary.

⚠ IMPORTANT: Do not mix chemicals under any circumstance. Keep handling and storage strictly separated.

⚠ IMPORTANT: For commercial use, follow all applicable local health and safety regulations related to water quality management, chemical storage, and dosing system operation.

⚠ IMPORTANT: Confirm that the dosing system is connected via Ethernet if using cloud-based monitoring. This enables real-time performance tracking and alert notifications on compatible smart devices.

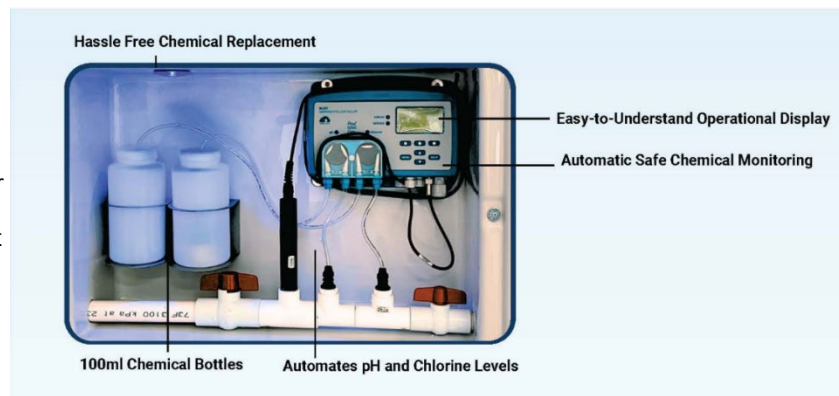

Sand Filter Installation Instruction

Unbox and Prepare Components. Carefully remove all components from the box. Your Contrast Therapy Commercial came with a sand filter.

Install the Filter

1. Remove the access door by gently pulling the top edge outward to release the magnets, then lift the ventilation screens upward to remove. Locate the filter housing inside.
2. Position the sand filter in the designated area inside the equipment bay.
3. Connect the multiport valve to the filter tank and ensure the gasket is seated properly.

Proper Set up

1. Fill the tank halfway with water to cushion the sand.
2. Add the correct amount of No. 20–40 silica sand slowly into the tank.
3. Attach the multiport valve securely and hand-tighten clamps; do not overtighten.

⚠ IMPORTANT NOTICE: Note the Flow Rate

- During installation, observe the initial water flow rate.
- A decrease in flow indicates the need for filter cleaning.
- Proper flow is essential for Contrast Therapy Commercial performance.

Filter Maintenance

The Filter replacement depends on the Contrast Therapy Commercial usage and maintenance. Please contact your closest Coast Spas authorized dealership for more information.

- Check the filter weekly.
- If you notice reduced water flow, clean the filter immediately.
- Never operate the chiller with inadequate water flow.

CAUTION

Do not use Contrast Therapy Commercial without a filter installed.

If you notice no water flow or suspect that the flow is not normal, immediately power off and unplug the Contrast Therapy Commercial. Contact the selling dealer's service department for assistance.

Damage caused by slow flow due to improper set up or lack of maintenance is not covered under the warranty. Always ensure proper installation and regular filter cleaning to maintain optimal performance.

Failure to clean the filter housing and replace the filter cartridge regularly, leading to slow or no water flow, may result in chiller damage. Coast Spas is not responsible for damage caused by improper maintenance.

IMPORTANT NOTICE

The Filter must be cleaned or replaced when required. Regular maintenance ensures optimal performance and prevents damage to the chiller.

The need for replacement may vary based on the following factors:

- Usage frequency – More frequent use may require more regular cleaning.
- Personal hygiene – Residues from lotions, oils, or sweat can clog the filter faster.
- Environmental conditions – High pollen levels, dust, or outdoor placement may necessitate more frequent cleaning.

To maintain proper water flow and efficiency, always inspect the filter weekly and maintain as needed.

Contrast Therapy Commercial How-To Videos



Start-up and Filling



Draining Instructions



Care & Maintenance

For more How-To Videos you may click the link below or scan the QR code.

https://www.youtube.com/playlist?list=PLGuCzEgLVx0nfSISGoQzRr9a33C_Rvr_m8



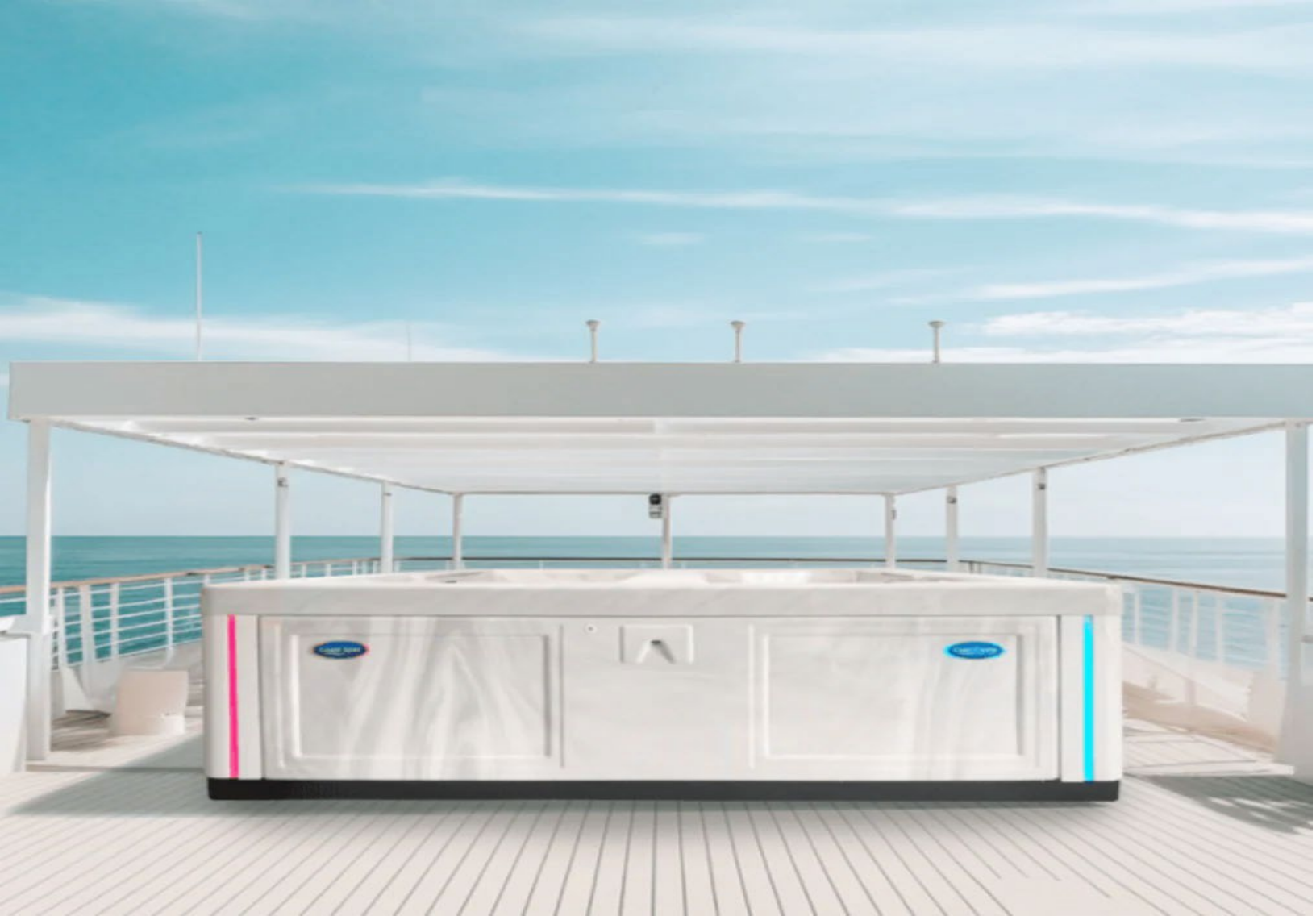

WORLD'S BEST BUILT SPAS